



2018 Full Line Catalog

Follow me, I've got a Superwinch.

Whether you winch to get away or winch to get back home safely, we're pushing the boundaries of modern winching from our new state-of-the-art headquarters in Tualatin, Oregon.

Never before has innovative design, advanced performance goals and a world-class manufacturing team combined behind one goal: building the industry's best winches.

Our ground-breaking and award-winning EXP Series now serving up a whopping 18,000 lb capacity perfect for large trucks or industrial need packaged in an integrated design. The combination of advanced electronic monitoring of winch health, next-generation waterproofing and remarkable auto-engage clutch continue to propel Superwinch's EXP line to the top of everyone's list.

Even if you don't seek our premium projects, Superwinch has a remarkable portfolio of winch performers that are built for durability and strength. Winches like our S Series Trailer line (refreshed for 2018), X Series utility winches or our clever winch-in-a-box are industry favorites. Superwinch can make any job easier.

We invite you to follow up on our website: Superwinch.com where we've stashed videos of winching use, tools and accessories to help you get the most out of your winch.

Contents

EXP 12,000-8,000

EXP 12 Synthetic.....	5	EXP 10 Wire.....	8	EXP Dimensions.....	11
EXP 12 Wire.....	6	EXP 8 Synthetic.....	9		
EXP 10 Synthetic.....	7	EXP 8 Wire.....	10		

EXP 18,000-14,000

EXP 18.....	13	EXP 14.....	15	EXP Accessories.....	17
EXP 16.....	14	EXP Accessories.....	16		

17,500-8,000 Tiger Shark and LP Series

Tiger Shark Small Frame.....	19	Tiger Shark Large frame.....	21	LP.....	22
------------------------------	----	------------------------------	----	---------	----

Terra ATV/UTV Series

Terra 25.....	24	Terra 35.....	25	Terra 45.....	26
---------------	----	---------------	----	---------------	----

LT Series

LT4000.....	28	LT2000/LT3000.....	29
-------------	----	--------------------	----

Trailer Winches

S5000.....	31	S4000.....	32	S3000.....	33
------------	----	------------	----	------------	----

Portable Winches

Winch2Go.....	35
---------------	----

Utility Winches

UT3000.....	37	SAC 1000.....	41	Hubs.....	44
X Series.....	38	AC1000/AC1500.....	42	Mounting Systems.....	45
AC3000/AC2000.....	40	Crane Winch C1000.....	43	ATV Mounting Chart.....	46

Winch Rigging

Accessory Kits.....	48	Straps & Gloves.....	50
Bow Shackles, Pulley Blocks & Rope Extensions.....	49	Covers, Remotes & Electrical.....	51

Superwinch Industrial

SI Series 12,000 Electric.....	53	SI Series 10,000 Hydraulic.....	56	SI Accessories.....	59
SI Series 12,000 Hydraulic.....	54	SI Series 8,000 Electric.....	57		
SI Series 10,000 Electric.....	55	SI Series 8,000 Hydraulic.....	58		



EXP 12,000-8,000



Superwinch's new flagship winch series: the EXP. Designed from the ground up, using Superwinch's more than 5 decades of winching know-how, the EXP is the future of winching.

Faster than the competition, the EXP Series packs industry-leading innovation. Things like waterproof electronics potted in compound. And advances like winch health notifications that buzz handheld remotes (wired or wireless). These are innovations you'll notice on your first EXP winching experience and they make all the difference in the world.

Superwinch EXP Series Stand Out Features:

- Industry's best waterproofing: potted electronics.
- Auto-engage clutch – remote automatically re-engages gearing saving a trip back to the winch.
- Wireless onboard – every EXP features a wireless receiver – the remote is sold as an aftermarket option.
- Sensors watch amp draw and alert users to danger in two ways:
 - Winch health status light on the solenoid box.
 - Tactile handheld remote buzz.
- Auxiliary powerports give you access to your batteries power to run lights or compressor – right from the winch.
- Picatinny Accessory Mount Rails provide a stable platform to mount lights, cameras and more.
- LED Task Lighting illuminates sockets, ports and drum for easier and safer nighttime operation.
- Hand built in Portland, Oregon, USA.

EXP 12 Synthetic

We are Expedition Grade: introducing the Superwinch EXP Series the world's most advanced winch ever created. Don't let the good looks fool you, there's a raging beast of a winch under the hood. Faster line speeds, lower amp draw plus 100' of rope and we're just getting started.

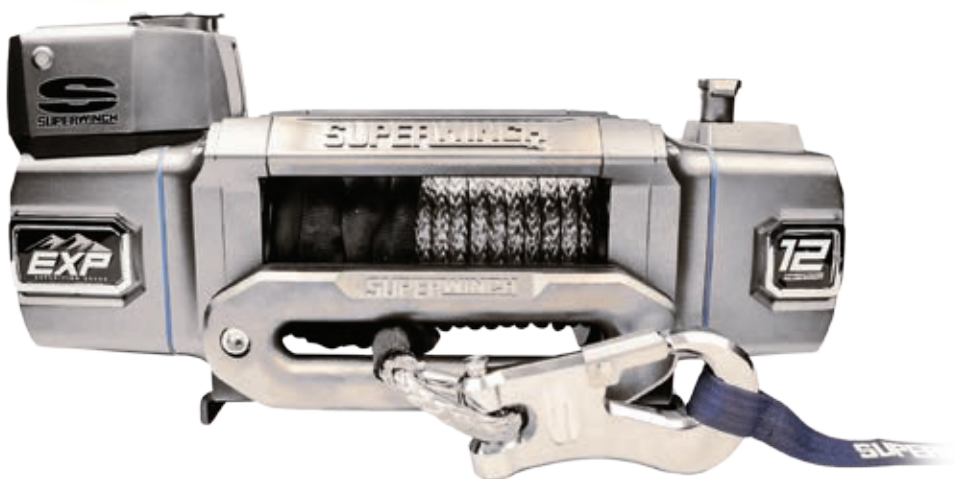

Standout Features

Motor	Series Wound
Electrical Controls	Expedition Grade potted solenoid/contacter
Remote Control	12' wired remote plus wireless ready
Auto-Off	Momentary button wakes winch/enters service mode
Geartrain	3-Stage Planetary
Gear Ratio	154:1
Clutch	Auto-Engage Manual twist – Patent Pending
Brake	Custom Load-holding disc brake on gearbox end
Battery Leads	96 in (2.4m) x 2 gauge
Task Lighting	Remote and Auxiliary Power Sockets and Drum
# of Fused Power Ports	2 (left side and on rear of winch)
Accessory Mounting	Mil spec Picatinny Rails
Finish	Exclusive Chromate Bath Powder Coating
Mounting Bolt Pattern	10 in x 4.5 in

Superwinch EXP Specs

Model	Rope	Length	Diameter	Fairlead/Hawse
EXPi 12S	Synthetic	100 ft	3/8 in	Hawse
EXP 12S	Synthetic	100 ft	3/8 in	Hawse

EXP 12,000 (All Models)

LOAD	AMPS	LINE SPEED
0	74	44
2000	165	22.5
4000	230	16.5
6000	315	13
8000	380	10.5
10000	460	8
12000	530	6

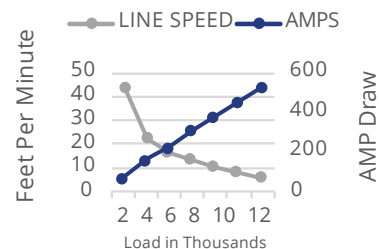

*See page 11 for dimensional line drawings.

EXP 12 Wire

Superwinch built two versions, a centered (or integrated) design and a non-integrated as a difficult-to-fit installation solution. The first winch of its kind featuring time-saving auto-engage clutch, waterproof electronics, auto off wireless to protect your battery and so much more.



Standout Features	
Motor	Series Wound
Electrical Controls	Expedition Grade potted solenoid/contactors
Remote Control	12' wired remote plus wireless ready
Auto-Off	Momentary button wakes winch/enters service mode
Geartrain	3-Stage Planetary
Gear Ratio	154:1
Clutch	Auto-Engage Manual twist – Patent Pending
Brake	Custom Load-holding disc brake on gearbox end
Battery Leads	96 in (2.4m) x 2 gauge
Task Lighting	Remote and Auxiliary Power Sockets and Drum
# of Fused Power Ports	2 (left side and on rear of winch)
Accessory Mounting	Mil spec Picatinny Rails
Finish	Exclusive Chromate Bath Powder Coating
Mounting Bolt Pattern	10 in x 4.5 in

Superwinch EXP Specs				
Model	Rope	Length	Diameter	Fairlead/Hawse
EXPi 12	Wire	100 ft	3/8 in	Fairlead
EXP 12	Wire	100 ft	3/8 in	Fairlead

EXP 12,000 (All Models)			
LOAD	AMPS	LINE SPEED	
0	74	44	
2000	165	22.5	
4000	230	16.5	
6000	315	13	
8000	380	10.5	
10000	460	8	
12000	530	6	

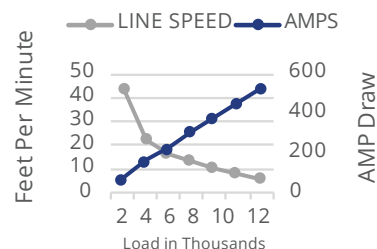

*See page 11 for dimensional line drawings.

EXP 10 Synthetic

Meet the future of winching – aluminum housing, potted electronics, high-torque motors and advanced gearing with Auto-Engage – there’s a lot to love in the new Superwinch EXP Series, handmade in Tualatin, Oregon.

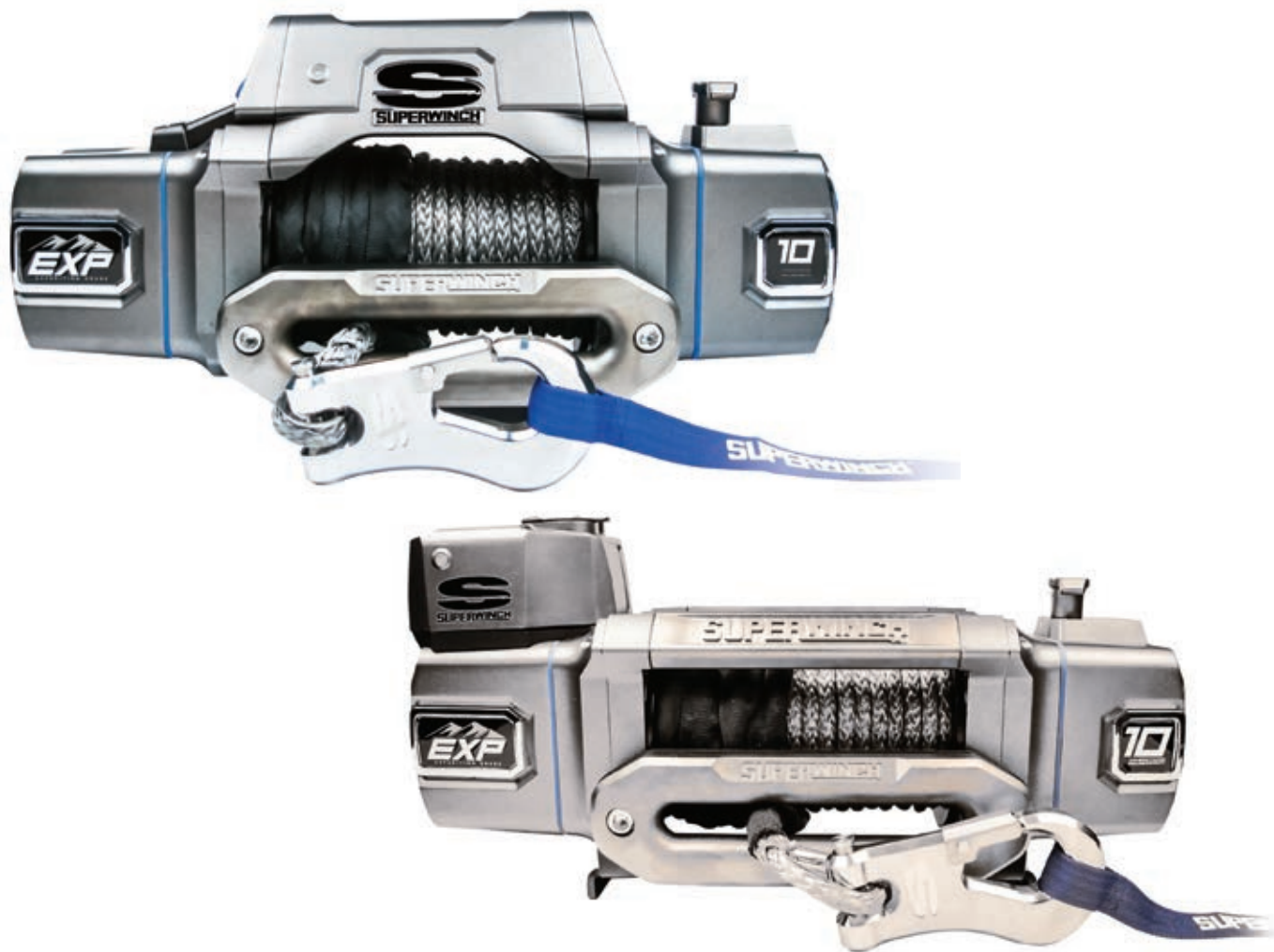

Standout Features	
Motor	Series Wound
Electrical Controls	Expedition Grade potted solenoid/contactor
Remote Control	12' wired remote plus wireless ready
Auto-Off	Momentary button wakes winch/enters service mode
Geartrain	3-Stage Planetary
Gear Ratio	154:1
Clutch	Auto-Engage Manual twist – Patent Pending
Brake	Custom Load-holding disc brake on gearbox end
Battery Leads	96 in (2.4m) x 2 gauge
Task Lighting	Remote and Auxiliary Power Sockets and Drum
# of Fused Power Ports	2 (left side and on rear of winch)
Accessory Mounting	Mil spec Picatinny Rails
Finish	Exclusive Chromate Bath Powder Coating
Mounting Bolt Pattern	10 in x 4.5 in

Superwinch EXP Specs				
Model	Rope	Length	Diameter	Fairlead/Hawse
EXPi 10S	Synthetic	100 ft	3/8 in	Hawse
EXP 10S	Synthetic	100 ft	3/8 in	Hawse

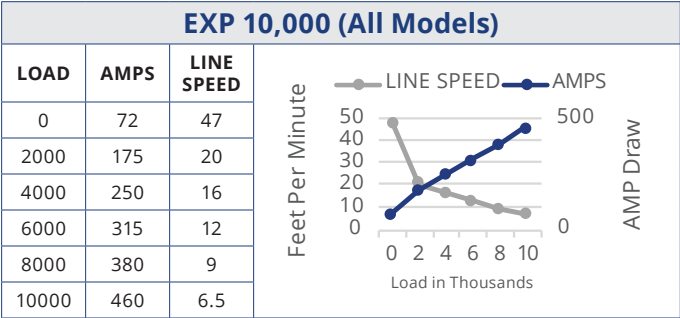

*See page 11 for dimensional line drawings.

EXP 10 Wire

Superwinch’s wire rope options allow users to run trusted cable with the option to run synthetic rope down the line thanks to reinforced drums and a brake outside the gearbox.

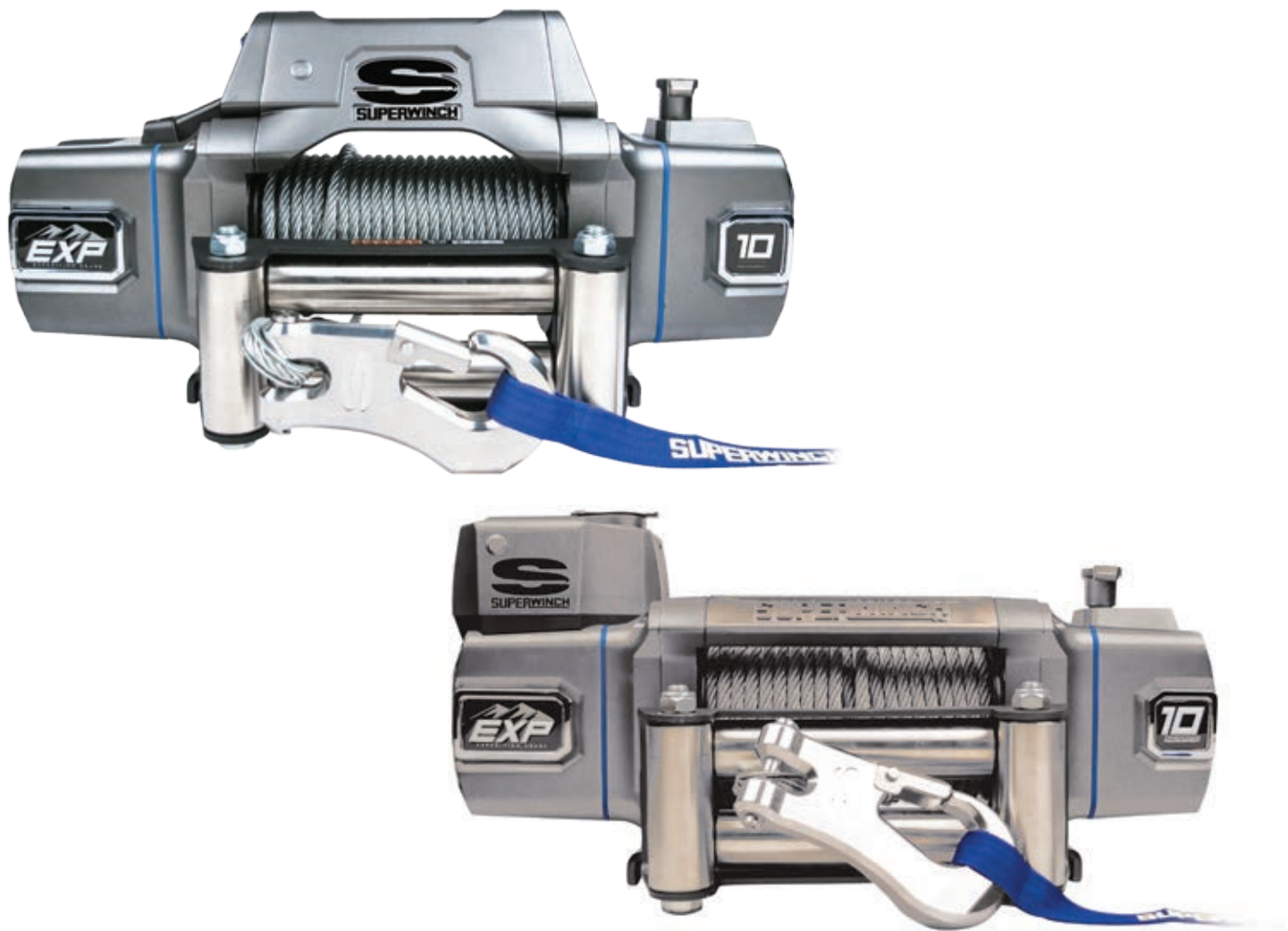

Standout Features	
Motor	Series Wound
Electrical Controls	Expedition Grade potted solenoid/contactor
Remote Control	12' wired remote plus wireless ready
Auto-Off	Momentary button wakes winch/enters service mode
Geartrain	3-Stage Planetary
Gear Ratio	154:1
Clutch	Auto-Engage Manual twist – Patent Pending
Brake	Custom Load-holding disc brake on gearbox end
Battery Leads	96 in (2.4m) x 2 gauge
Task Lighting	Remote and Auxiliary Power Sockets and Drum
# of Fused Power Ports	2 (left side and on rear of winch)
Accessory Mounting	Mil spec Picatinny Rails
Finish	Exclusive Chromate Bath Powder Coating
Mounting Bolt Pattern	10 in x 4.5 in

Superwinch EXP Specs				
Model	Rope	Length	Diameter	Fairlead/Hawse
EXPi 10	Wire	100 ft	3/8 in	Fairlead
EXP 10	Wire	100 ft	3/8 in	Fairlead

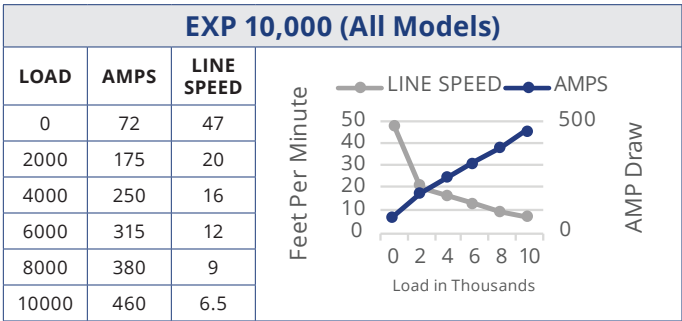

*See page 11 for dimensional line drawings.

EXP 8 Synthetic

The ultimate in lightweight performance winching! The EXP 8 features an 8,000 pound capacity in a monster of a machine built in our new factory in Tualatin, Oregon. Smarter electronics, faster line speed and sealed to the best in industry standards.

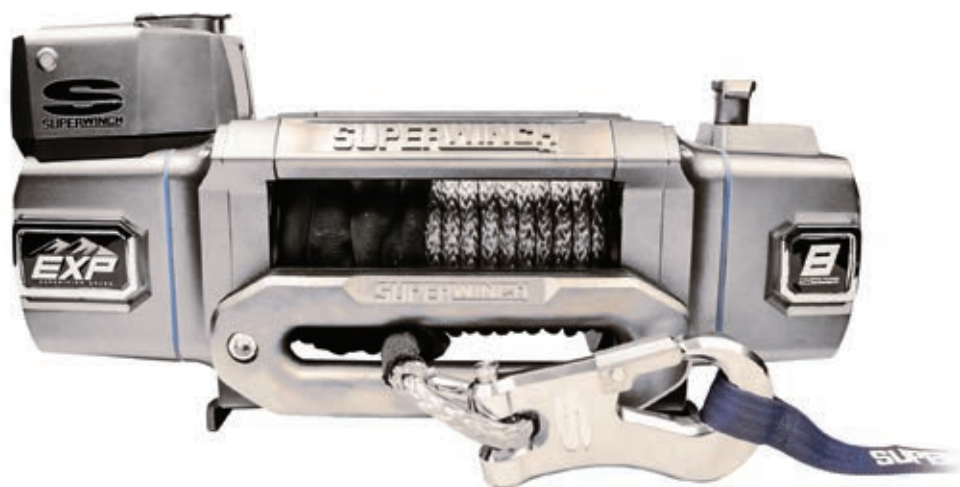
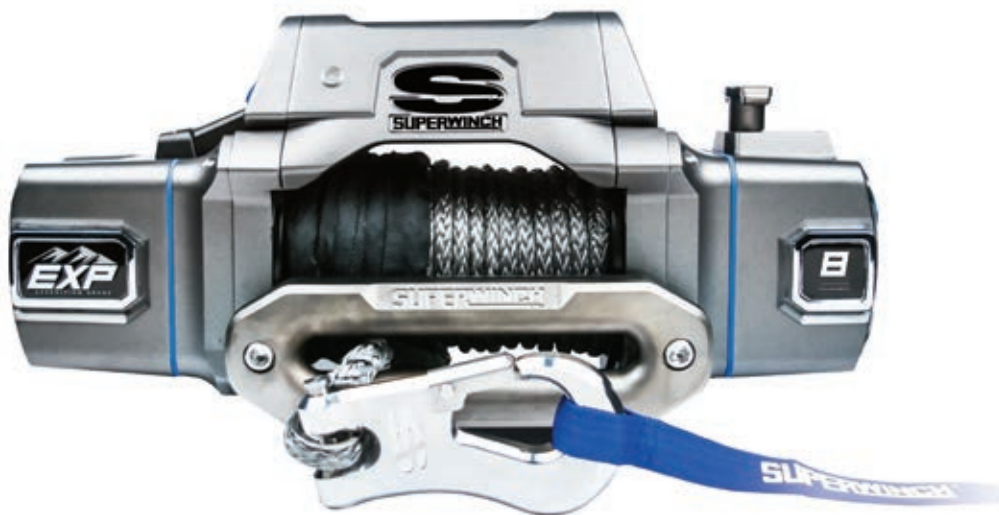

Standout Features	
Motor	Series Wound
Electrical Controls	Expedition Grade potted solenoid/contactor
Remote Control	12' wired remote plus wireless ready
Auto-Off	Momentary button wakes winch/enters service mode
Geartrain	3-Stage Planetary
Gear Ratio	154:1
Clutch	Auto-Engage Manual twist – Patent Pending
Brake	Custom Load-holding disc brake on gearbox end
Battery Leads	96 in (2.4m) x 2 gauge
Task Lighting	Remote and Auxiliary Power Sockets and Drum
# of Fused Power Ports	2 (left side and on rear of winch)
Accessory Mounting	Mil spec Picatinny Rails
Finish	Exclusive Chromate Bath Powder Coating
Mounting Bolt Pattern	10 in x 4.5 in

Superwinch EXP Specs				
Model	Rope	Length	Diameter	Fairlead/Hawse
EXPi 8S	Synthetic	100 ft	5/16 in	Hawse
EXP 8S	Synthetic	100 ft	5/16 in	Hawse

EXP 8,000 (All Models)				
LOAD	AMPS	LINE SPEED	<div> <div>LINE SPEED</div> <div>AMPS</div> </div>	
0	74	46		
2000	170	21.5	<div> <div>Feet Per Minute</div> <div> <div>50</div> <div>40</div> <div>30</div> <div>20</div> <div>10</div> <div>0</div> </div> <div> <div>0</div> <div>2</div> <div>4</div> <div>6</div> <div>8</div> </div> <div>Load in Thousands</div> </div>	<div> <div>500</div> <div>0</div> </div> <div>AMP Draw</div>
4000	240	15.5		
6000	320	11		
8000	400	8.75		

*See page 11 for dimensional line drawings.

EXP 8 Wire

Superwinch combines advanced electronics, convenient auto-engage clutch and beefy construction to insure your EXP is up to the challenge.



Standout Features	
Motor	Series Wound
Electrical Controls	Expedition Grade potted solenoid/contactor
Remote Control	12' wired remote plus wireless ready
Auto-Off	Momentary button wakes winch/enters service mode
Geartrain	3-Stage Planetary
Gear Ratio	154:1
Clutch	Auto-Engage Manual twist – Patent Pending
Brake	Custom Load-holding disc brake on gearbox end
Battery Leads	96 in (2.4m) x 2 gauge
Task Lighting	Remote and Auxiliary Power Sockets and Drum
# of Fused Power Ports	2 (left side and on rear of winch)
Accessory Mounting	Mil spec Picatinny Rails
Finish	Exclusive Chromate Bath Powder Coating
Mounting Bolt Pattern	10 in x 4.5 in

Superwinch EXP Specs				
Model	Rope	Length	Diameter	Fairlead/Hawse
EXPi 8	Wire	100 ft	5/16 in	Fairlead
EXP 8	Wire	100 ft	5/16 in	Fairlead

EXP 8,000 (All Models)			
LOAD	AMPS	LINE SPEED	
0	74	46	
2000	170	21.5	
4000	240	15.5	
6000	320	11	
8000	400	8.75	

*See page 11 for dimensional line drawings.

EXP Dimensions

EXP Integrated

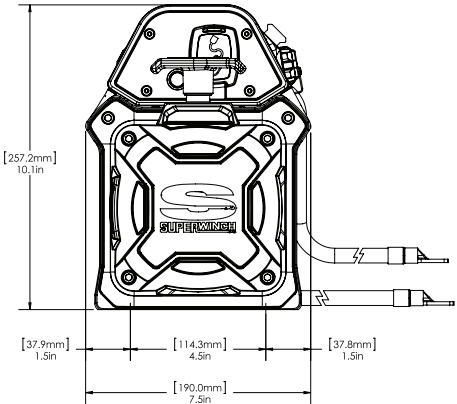
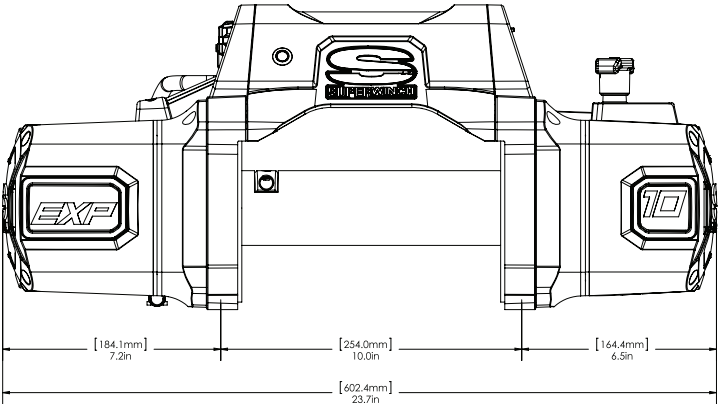

EXP Non-Integrated

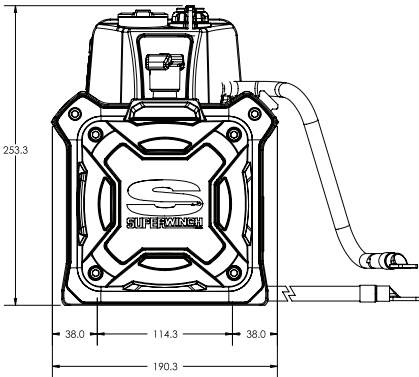
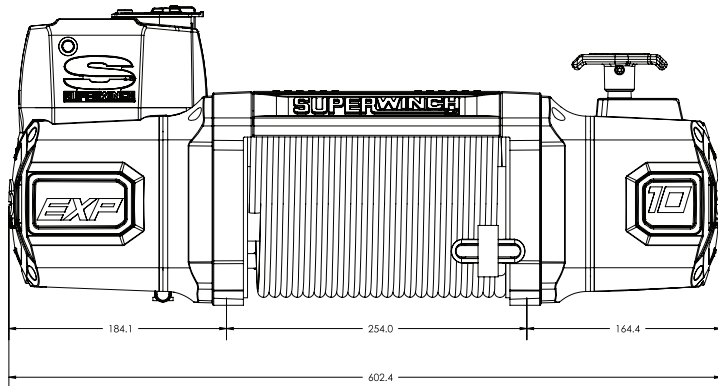

EXP 18,000-14,000



Building on the success of the EXP, Superwinch is bringing state-of-the-art winching benefits to large capacity winches up to 18,000lbs. Built for big machines these premium winches feature the EXP's most popular features: auto-engage clutch, task lighting, winch health notifications, auxiliary power and more.

EXP 18

Built for the biggest applications, the EXP 18 has the most premium features of any winch on the market. From auxiliary power ports to winch health indicators (both visual and tactile) to performance upgrades like advanced waterproofing and a fast gearbox, there's nothing like the new Superwinch EXP.



Specifications	
Model	18,000 Capacity
Part Number	S104440 (18S), S104439 (18), S104438 (18SI), S104437 (18I)
Motor	Series Wound
Electrical Controls	Expedition Grade Potted Solenoid/ Contactor
Remote Control	15' Wired Plus Built-In Wireless
Auto Off	Winch Awakes By Momentary Button
Geartrain	3-Stage Planetary
Gear Ratio	300:1
Clutch	Auto Engage With Manual Twist
Brake	Custom Load-Holding Disc Brake On Gearbox End
Battery Leads	96 In (2.4M) X 2 Gauge
Task Lighting	Remote And Aux Power Sockets And Drum
# Of Fused Power Ports	2 Left Side And Rear Of Winch
Accessory Mounting	Mil Spec Picatinny Rails

Performance		
LOAD	AMPS	LINE SPEED
0	80	25.7
3000	180	15
6000	260	12
9000	325	9
12000	390	7
15000	460	5.5
18000	550	4

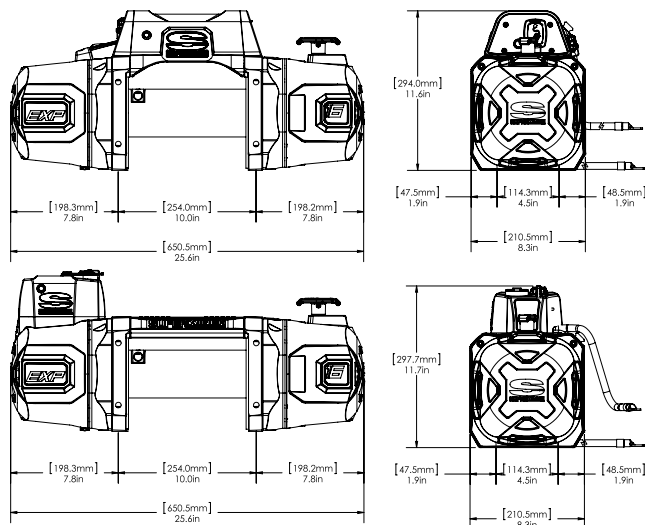

EXP 16

Featuring fast line speeds and 16,000 lbs of pulling performance, the EXP 16 sets the bar for premium pulling. Available wired or wireless control, auto-engage clutch and two options for solenoid housing, the EXP is built to be as flexible a platform as you need.



Specifications	
Model	16,000 Capacity
Part Number	S104436 (16), S104435 (16), S104434 (16SI), S104433 (16I)
Motor	Series Wound
Electrical Controls	Expedition Grade Potted Solenoid/ Contactor
Remote Control	15' Wired Plus Built-In Wireless
Auto Off	Winch Awakes By Momentary Button
Geartrain	3-Stage Planetary
Gear Ratio	300:1
Clutch	Auto Engage With Manual Twist
Brake	Custom Load-Holding Disc Brake On Gearbox End
Battery Leads	96 In (2.4M) X 2 Gauge
Task Lighting	Remote And Aux Power Sockets And Drum
# Of Fused Power Ports	2 Left Side And Rear Of Winch
Accessory Mounting	Mil Spec Picatinny Rails

Performance		
LOAD	AMPS	LINE SPEED
0	50.8	85
4000	13.3	181
8000	7.5	295
12000	5.3	401
16000	4.2	500

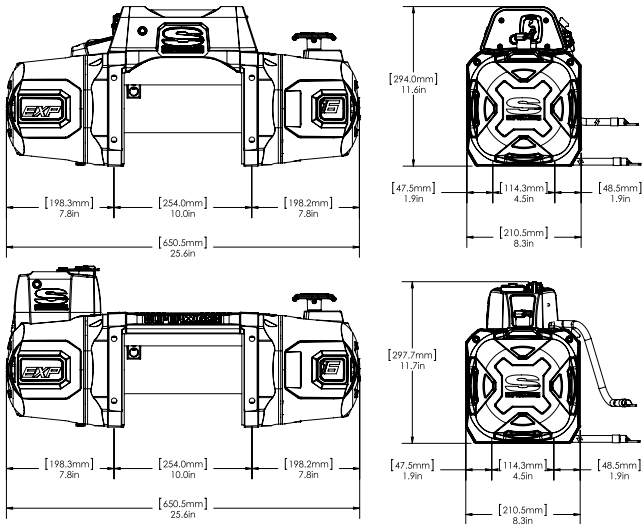

EXP 14

Built to lead the industry, the EXP 14 features 14,000 of pulling force outfitted with the latest advancements in control, health notifications and performance. There’s nothing like the EXP 14.



Specifications	
Model	14,000 Capacity
Part Number	S104432 (14S), S104431 (14), S104430 (14SI), S104429 (14I)
Motor	Series Wound
Electrical Controls	Expedition Grade Potted Solenoid/ Contactor
Remote Control	15’ Wired Plus Built-In Wireless
Auto Off	Winch Awakes By Momentary Button
Geartrain	3-Stage Planetary
Gear Ratio	300:1
Clutch	Auto Engage With Manual Twist
Brake	Custom Load-Holding Disc Brake On Gearbox End
Battery Leads	96 In (2.4M) X 2 Gauge
Task Lighting	Remote And Aux Power Sockets And Drum
# Of Fused Power Ports	2 Left Side And Rear Of Winch
Accessory Mounting	Mil Spec Picatinny Rails

Performance		
LOAD	AMPS	LINE SPEED
0	80	56.7
3500	167	15
7000	267	8.4
10500	362	6
14000	450	4.7

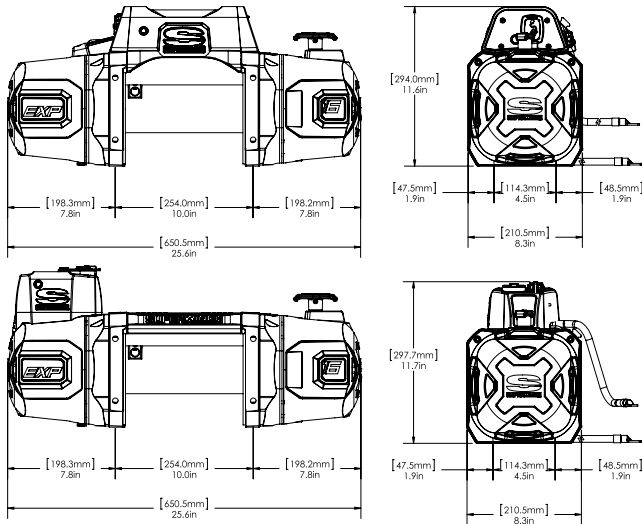

EXP Accessories

EXP Powerport Wiring Harness

S103388

Access the EXP Series Power Port with this wiring harness to connect your lights, compressors or other electrical gear. Includes Power Port Harness and crimps.



EXP Rail Brackets (Pair)

S103389

Powder coated brackets attach to Picatinny rails on the Superwinch EXP Series winches and make the perfect mounting platform for lights, cameras and more.

EXP Wireless Accessory Controller

S103390

Control your accessory with the Superwinch wireless remote and power solution combo. Provides connection to the Superwinch EXP auxiliary power port and wireless receiver and remote.



EXP Wireless Winch Remote

S103393

Access the wireless control built into every Superwinch EXP Series winch. Simply pair this remote with your winch and you'll be wireless ready! Compatible with Superwinch EXP Series winches only.

EXP Accessories

EXP Control Pack Relocation Kit

S103396

Take your EXP non-integrated control pack and remote locate in a spot that works for your installation. 8' battery leads will provide a wide range of options.



EXP Light Syst W/WI Controller (Bd-S2)

S103391

A special collaboration with Baja Designs brings this LED light kit – a complete set up that includes: Baja Designs S2 lights, mounting brackets, wireless control and power harness.

EXP Light Bar W/WI Controller (Bd S8 10")

S103392

A special collaboration with Baja Designs brings this LED light kit – a complete set up that includes: Baja Designs Lightbar, mounting brackets, wireless control and power harness.



EXP Light Syst W/WI Controller (Bd-Squad Spt)

S104347

A special collaboration with Baja Designs brings this LED light kit – a complete set up that includes: Baja Designs Squadron Sport lights, mounting brackets, wireless control and power harness.

17,500-8,000 Tiger Shark and LP Series



One of Superwinch's most popular winches, the Tiger Shark Series sets the bar for performance winching while not breaking the bank. From stainless steel tie bars, rollers and hardware to a fabricated steel drum that's ready for synthetic rope, there's nothing the Tiger Shark can't take a bite from.

Tiger Shark Small Frame

The Superwinch Tiger Shark is the best value on the Jeep/truck winch market today, bar none. From powerful motors, to strong gears to long-life stainless steel parts, the Tiger Shark is a standout choice. It is easy to see why this is one of Superwinch's most popular winches year after year.



9500



11500

Specifications		
Model	9500	11500
Part Number	1595200	1511200
Voltage	12 VDC	12 VDC
Rated Pull lbs (kg)	9500 (4309)	11500 (5216)
Motor hp (kW)	5.2 (3.8)	6.0 (4.48)
Gearing	3-Stage Planetary	
Gear Ratio	218:1	
Solenoid	Weather Sealed	
Freespool	Ergonomic Pull and Turn	
Brake	Mechanical, Automatic, Load Holding	
Rope Length ' (m)	95 (28)	84 (26)
Rope Dia " (mm)	21/64 (8.3)	3/8 (9.5)
Hook	Heavy Duty/Clevis Pinned/Latched	
Fairlead/Hawse	Stainless Steel 4-way Roller Fairlead	
Remote Control	Rugged Rubberized Handheld	
Weight Installed lbs (kg)	90 (41)	94 (42)
Weight Shipping lbs (kg)	94 (42)	98 (44)
Warranty	Limited 2-Year Warranty / 1-Year Electrical	
UPC	022705003605	022705003612

Performance			
Model		9500	11500
No Load	Amps	80	80
	Line Speed FPM (MPM)	19 (5.7)	19 (5.7)
At Load	Amps	340	410
	Line Speed FPM (MPM)	4 (1.2)	2 (0.6)

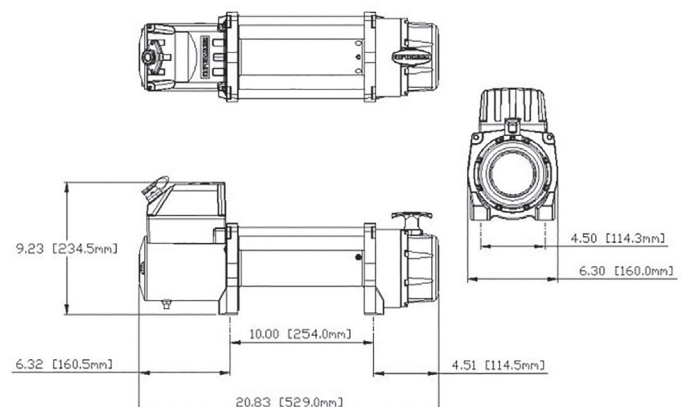

Tiger Shark Small Frame

Superwinch Tiger Shark Synthetic models are better than the competition in 3 ways: better drums (thicker, fabricated steel) a relocated brake (outside the drum to protect rope from heat) and Certified Dyneema rope (the best there is). Dollar for dollar, there's not better winch than the Superwinch Tiger Shark.



9500SR



11500SR

Specifications		
Model	9500SR	11500SR
Part Number	1595201	1511201
Voltage	12 VDC	12 VDC
Rated Pull lbs (kg)	9500 (4309)	11500 (5216)
Motor hp (kW)	5.2 (3.8)	6.0 (4.48)
Gearing	3-Stage Planetary	
Gear Ratio	218:1	
Solenoid	Weather Sealed	
Freespool	Ergonomic Pull and Turn	
Brake	Mechanical, Automatic, Load Holding	
Rope Length ' (m)	80 (24.4)	80 (24.4)
Rope Dia " (mm)	3/8 (9.5)	
Hook	Heavy Duty/Clevis Pinned/Latched	
Fairlead/Hawse	Stainless Steel 4-way Roller Fairlead	
Remote Control	Rugged Rubberized Handheld	
Weight Installed lbs (kg)	59 (26.7)	
Weight Shipping lbs (kg)	63 (285.6)	
Warranty	Limited 2-Year Warranty / 1-Year Electrical	
UPC	022705003605	022705003612

Performance			
Model		9500	11500
No Load	Amps	80	80
	Line Speed FPM (MPM)	19 (5.7)	19 (5.7)
At Load	Amps	340	410
	Line Speed FPM (MPM)	4 (1.2)	2 (0.6)

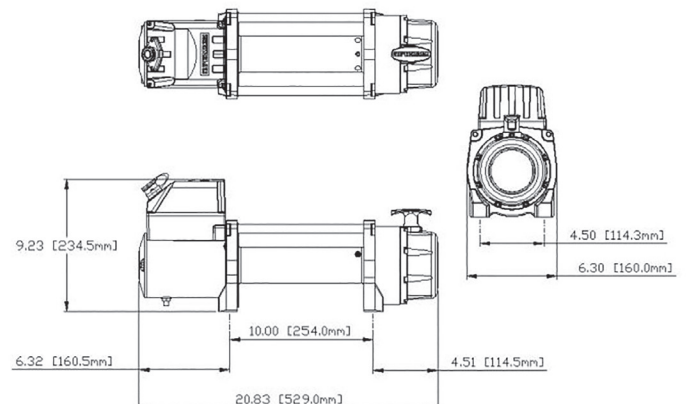

Tiger Shark Large frame

Perfect for trucks and trailers, Superwinch Tiger Shark large chassis adds more pulling power without braking the bank.



TS 13500



TS 15500



TS 17500

Specifications			
Model	13500	15500	17500
Part Number	1513200	1515200	1517200
Voltage	12 VDC	12 VDC	12 VDC
Rated Pull lbs (kg)	13500 (6123.5)	15500 (7031)	17500 (7938)
Motor hp (kW)	5.3 (3.95)	5.7 (4.25)	6.5 (4.84)
Gearing	4-Stage Planetary		
Gear Ratio	518:1		
Solenoid	Weather Sealed		
Freespool	Ergonomic Pull and Turn		
Brake	Mechanical, Automatic, Load Holding		
Rope Length ' (m)	95 (29)	92 (28)	90 (27.4)
Rope Dia " (mm)	13/32 (10.3)	29/64 (11.5)	1/2 (12.7)
Hook	Heavy Duty/Clevis Pinned/Latched		
Fairlead/Hawse	Stainless Steel 4-way Roller Fairlead		
Remote Control	Rugged Rubberized Handheld		
Weight Installed lbs (kg)	134 (60.7)	140 (63.5)	150 (68)
Weight Shipping lbs (kg)	138 (62.5)	144 (65)	154 (70)
Warranty	Limited 2-Year Warranty / 1-Year Electrical		
UPC	022705003629	022705003636	022705003643

Performance				
Model		13500	15500	17500
No Load	Amps	120		
	Line Speed FPM (MPM)	11 (3.4)		
At Load	Amps	440		
	Line Speed FPM (MPM)	4 (1.2)	3.5 (1)	2.8 (0.85)



LP 8500

LP 10000



Specifications		
Model	8500	10000
Part Number	1585202	1510200
Voltage	12 VDC	12 VDC
Rated Pull lbs (kg)	8500 (3856)	10000 (4536)
Motor hp (kW)	4.5 (303)	5.1 (3.8)
Gearing	3-Stage Planetary	
Gear Ratio	235:1	
Solenoid	Sealed Solenoid With Circuit Breaker	
Freespool	Ergonomic Pull and Turn	
Brake	Automatic/Load Holding	
Rope Length ' (m)	95 (29)	85 (25.9)
Rope Dia " (mm)	5/16 (7.9)	3/8 (9.5)
Hook	Heavy Duty/Clevis Pinned/Latched	
Fairlead/Hawse	Steel Hawse	Roller Fairlead
Remote Control	12' Rubber Handheld	
Weight Installed lbs (kg)	73 (33.11)	83 (37.64)
Weight Shipping lbs (kg)	90 (40.83)	
Warranty	Limited 2-Year Warranty	
UPC	0227050003407	00227050003414

Performance			
Model		8500	10000
No Load	Amps	84	90
	Line Speed FPM (MPM)	18 (5.5)	16 (4.87)
At Load	Amps	320	350
	Line Speed FPM (MPM)	3.5 (1.1)	1.52 (.46)

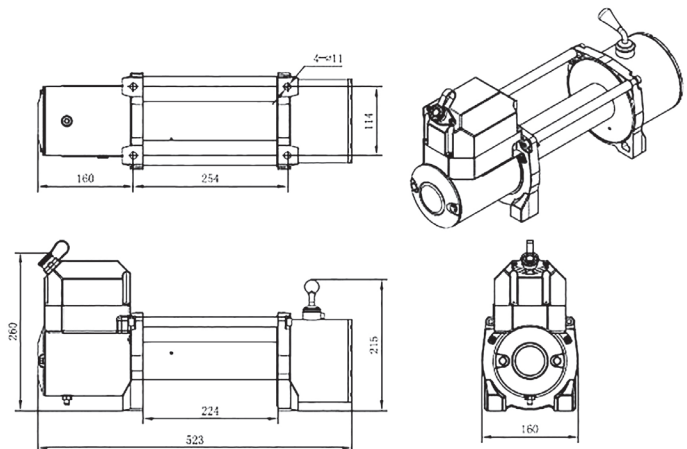

Terra ATV/UTV Series

The background of the page is a photograph showing the silhouettes of two people riding ATVs. They are positioned on the left and right sides of the frame, facing each other. The sky is a vibrant orange and yellow, with a large, bright sun in the center, creating a strong backlighting effect. The overall mood is adventurous and energetic.

The Superwinch Terra Series is the standout performer in ATV/UTV winching. From bigger gears to large-diameter motor, there's a Superwinch Terra in capacities of 2,500/3,500/4,500.

Terra 25



Terra 25

Terra 25SR



Specifications		
Model	25	25SR
Part Number	1125220	1125230
Voltage	12 VDC	12 VDC
Rated Pull lbs (kg)	2500 (1134)	
Motor hp (kW)	1.3 (.96)	
Gearing	3-Stage Planetary	
Gear Ratio	140:1	
Solenoid	Sealed Solenoid with Circuit Breaker	
Freespool	Ergonomic Control	
Brake	Mechanical, Automatic, Load Holding	
Rope Length ' (m)	50 (15.2)	
Rope Dia " (mm)	3/16 (4.8)	3/16 (4.8)
Hook	Heavy Duty/Clevis Pinned/Latched	
Fairlead/Hawse	Fairlead	Hawse
Remote Control	10' Rugged Handheld and Handbar Switch	
Weight Installed lbs (kg)	18 (8.2)	15 (6.8)
Weight Shipping lbs (kg)	29.5 (13.3)	23.7 (10.7)
Warranty	Limited Lifetime Warranty	
UPC	022705003421	022705003438

Performance		
Model	Terra 25 & 25SR	
	No Load	At Load
Line Speed	26 FPM (7.9 MPM)	10.5 FPM (3.2 MPM)
Amp Draw	25 Amps	162 Amps

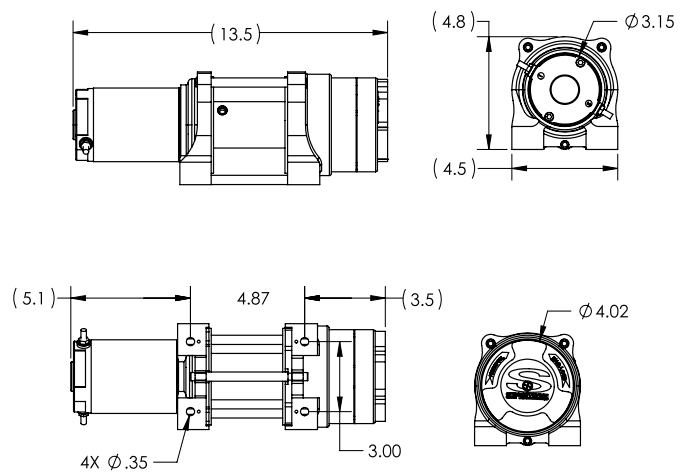

Terra 35



Terra 35

Terra 35SR



Specifications		
Model	35	35SR
Part Number	1135220	1135230
Voltage	12 VDC	12 VDC
Rated Pull lbs (kg)	3500 (1588)	
Motor hp (kW)	1.6 (1.2)	
Gearing	3-Stage Planetary	
Gear Ratio	140:1	
Solenoid	Sealed Solenoid with Circuit Breaker	
Freespool	Ergonomic Control	
Brake	Mechanical, Automatic, Load Holding	
Rope Length ' (m)	50 (15.2)	
Rope Dia " (mm)	13/64 (5.2)	3/16 (4.8)
Hook	Heavy Duty/Clevis Pinned/Latched	
Fairlead/Hawse	Fairlead	Hawse
Remote Control		
Weight Installed lbs (kg)	20 (9.1)	17 (7.7)
Weight Shipping lbs (kg)	30.9 (14.0)	25.2 (11.4)
Warranty	Limited Lifetime Warranty	
UPC	022705003445	022705003452

Performance		
Model	Terra 35 & 35SR	
	No Load	At Load
Line Speed	24 FPM (7.3 MPM)	10.2 FPM (3.1 MPM)
Amp Draw	19 Amps	190 Amps

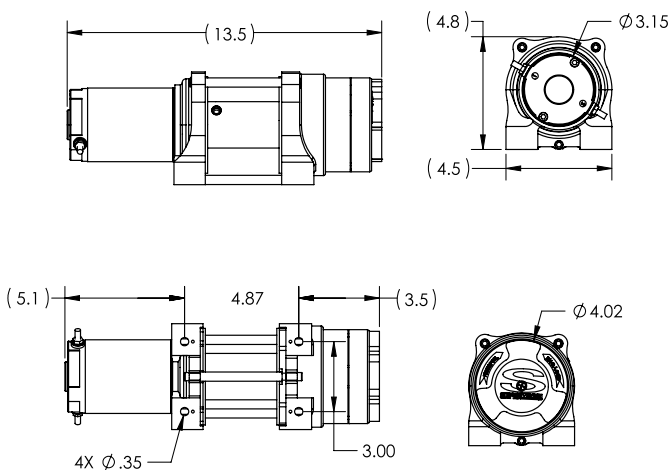

Terra 45



Terra 45

Terra 45SR



Specifications		
Model	45	45SR
Part Number	1145220	1145230
Voltage	12 VDC	12 VDC
Rated Pull lbs (kg)	4500 (2041)	
Motor hp (kW)	1.6 (1.2)	
Gearing	3-Stage Planetary	
Gear Ratio	191:1	
Solenoid	Sealed Solenoid with Circuit Breaker	
Freespool	Ergonomic Control	
Brake	Mechanical, Automatic, Load Holding	
Rope Length ' (m)	55 (16.8)	
Rope Dia " (mm)	1/4 (6.5)	
Hook	Heavy Duty/Clevis Pinned/Latched	
Fairlead/Hawse	Fairlead	Hawse
Remote Control	10' Rugged Handheld and Handbar Switch	
Weight Installed lbs (kg)	22 (10)	19 (8.6)
Weight Shipping lbs (kg)	34 (15.4)	27.9 (12.7)
Warranty	Limited Lifetime Warranty	
UPC	22705003469	22705003476

Performance		
Model	Terra 45 & 45SR	
	No Load	At Load
Line Speed	15 FPM (4.6 MPM)	4.5 FPM (13 MPM)
Amp Draw	21 Amps	178 Amps

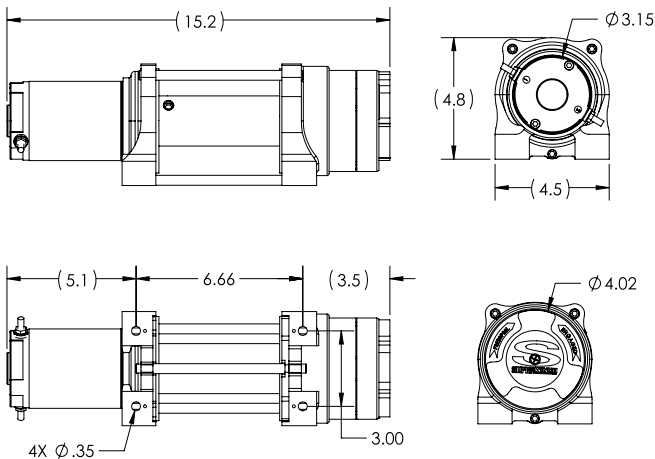

LT Series

Built for action, the LT and AX Series from Superwinch provide amazing pulling power from a small winch. Tried and true designs, perfected over the years offer unmatched durability and performance.



SUPERWINCH®

LT4000

The LT4000 is a great choice for a quality, well-built winch that delivers a powerful pull.



Specifications		
Model	LT4000	LT4000SR
Part Number	1140220	1125230
Rated Line Pull	4,000 lbs (1814 kgs)	
Motor	Sealed 1.4 hp motor	
Gearing	3-Stage Planetary	
Gear Ratio	166:01:00	
Solenoid	Sealed Solenoid; Circuit Breaker Protected	
Clutch	Free Spooling, Ergonomic Control	
Brake	Automatic, 100% Load Holding	
Rope	Wire Rope 50' x 3/16"	Synthetic Rope 50' x 3/16"
Hook	Heavy Duty Clevis Pinned Latched	
Fairlead	Heavy Duty 4-Way Roller	Aluminum Machined Hawse
Remote	12' Handheld plus Handle Bar Rocker Switch	
Dimensions	13.2"L x 4.25"W x 4.25"H (335.3mm L x 108mm W x 108mm H)	
Drum Diameter	2.0" (50.2mm)	
Drum Length	TBD	
Mounting Bolt Pattern	4.87" x 3.0"	
Installed Weight	25.0 lbs	
Shipping Weight	28.0 lbs	
Warranty	Two Year Limited	
UPC	0 22705 00334 6	
Battery Leads	6' x 6 Gauge	

Performance		
Model	LT4000/LT4000SR	
	No Load	At Load
Line Speed	18 FPM (5.4 MPM)	4.5 FPM (13 MPM)
Amp Draw	20 Amps	320 Amps

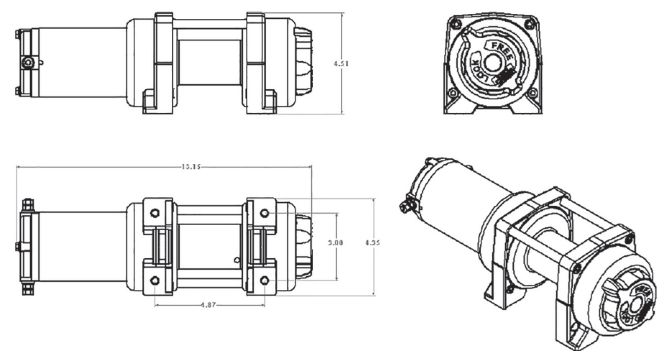

LT2000/LT3000

LT3000 is legendary because it survives pull after pull, season after season.



Specifications		
Model	LT2000	LT3000
Part Number	1120210	1130220
Rated Line Pull	2,000 lbs (907 kgs)	3,000 lbs (1,361 kgs)
Motor	1.0 HP Permanent Magnet	Sealed 1.2 HP Permanent Magnet
Gearing	1-Stage Planetary	1-Stage Planetary
Gear Ratio	153:01:00	136:01:00
Solenoid	Dual Relays and Circuit Breaker Protected	Sealed Solenoid, Circuit Breaker Protected
Clutch	Free-Spooling, Pull and Turn	Free-Spooling, Ergonomic Control
Brake	Dynamic	Automatic, 100% Load Holding
Rope	Wire Rope 5/32" x 50' (3.9mm x 15.2m)	Wire Rope 3/16" x 50' (4.8mm x 15.0m)
Hook	Permanent/Latched	Heavy-Duty, Clevis Pinned Latch
Fairlead	4-Way Roller	Heavy-Duty 4-Way Roller
Remote	Handle Bar Mounted Rocker Switch	12' Hand-Held

Dimensions	11.0" L x 4.1" D x 4.1" H (285mm L x 105mm D x 105mm H)	13.2" L x 4.25" W x 4.25" H (335.3mm L x 108mm W x 108mm H)
Drum Diameter	1.25" (31.8mm)	2.0" (50.2mm)
Drum Length	2.83" (72.0mm)	2.9" (74mm)
Mounting Bolt Pattern	2 Hole, 3.15" (80mm) on center	3.0" x 4.87" (76mm x 124mm)
Installed Weight	14.2 lbs (6.44 kgs)	20.0 lbs (9.0 kgs)
Shipping Weight	18.75 lbs (8.5 kgs)	27 lbs (12.24 kgs)
Warranty	One-Year Limited Warranty	Two Year Limited
UPC	0 22705 00265 3	0 22705 00316 2
Battery Leads	9 foot with inline remote	6' x 6 Gauge

Performance		
Model	LT3000/LT2000	
	No Load	At Load
Line Speed	10 FPM (3.0 MPM)	2.5 FPM (0.8 MPM)
Amp Draw	10 Amps	100 Amps

Trailer Winches

Superwinch S Series is back. The classic, compact and capable trailer winch returns with its weatherproof cover, powerful motor and integrated roller fairlead.



SUPERWINCH

S5000

With 5,000lbs of pull, the S5000 is the perfect trailer winch: small in size but giant in performance.



Specifications	
Model	S5000
Part Number	S104176
Rated Line Pull	5,000 lbs (2,268 kgs)
Motor	2.1 hp Series Wound
Gearing	Differential Planetary
Gear Ratio	159:01:00
Solenoid	S3™ Sealed Submersible Solenoid (3 Yr. Warranty) and Circuit Breaker Protected
Clutch	Free-Spooling, Lever Action
Brake	Mechanical and Dynamic
Rope	Wire Rope 1/4" x 50' (6.4mm x 15.2m)
Hook	Latched
Fairlead	Roller
Remote	30' Hand-held
Dimensions	15.1" L x 8.7" D x 6.0" H (383mm L x 221mm D x 152mm H)
Drum Diameter	1.625" (41.3mm)
Drum Length	3.0" (76.2mm)
Mounting Bolt Pattern	2 Hole, 3.69" (93.7mm) on Center
Installed Weight	38.9 lbs (17.6 kgs)
Shipping Weight	40 lbs (18.1 kgs)
Warranty	Limited Lifetime Warranty/3 Year on Solenoid
UPC	0 22705 00035 2

Performance		
No Load	Amps	36
	Line Speed fpm (mpm)	31.0 FPM (9.4 MPM)
At Load	Amps	350
	Line Speed fpm (mpm)	4.5 FPM (1.4 MPM)

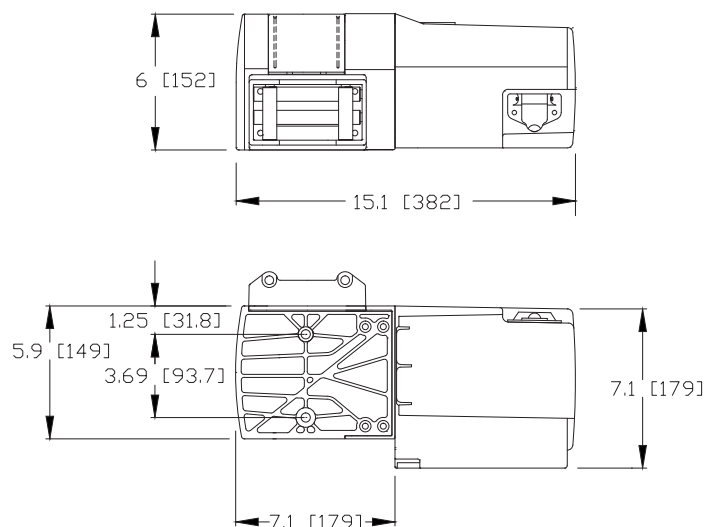

S4000

The Superwinch S4000 hits the sweet spot of power plus capacity with a legacy of reliability.



Specifications	
Model	S4000
Part Number	S104159
Rated Line Pull	4,000 lbs (1,814 kgs)
Motor	1.8 hp Series Wound
Gearing	Differential Planetary
Gear Ratio	159:01:00
Solenoid	S3™ Sealed Submersible Solenoid (3 Yr. Warranty) and Circuit Breaker Protected
Clutch	Free-Spooling, Lever Action
Brake	Mechanical and Dynamic
Rope	Wire Rope 7/32" x 60' (5.6mm x 18.2m)
Hook	Permanent/Latched
Fairlead	4-Way Roller
Remote	30' Sealed, Hand-held
Dimensions	15.1" L x 8.7" D x 6.0" H (383mm L x 221mm D x 152mm H)
Drum Diameter	1.625" (41.3mm)
Drum Length	3.0" (76.2mm)
Mounting Bolt Pattern	2 Hole, 3.69" (93.7mm) on Center
Installed Weight	28.2 lbs (12.79 kgs)
Shipping Weight	33.5 lbs (15.2)
Warranty	Limited Lifetime Warranty/3 Year on Solenoid
UPC	0 22705 00034 5

Performance		
No Load	Amps	30
	Line Speed fpm (mpm)	21.6 FPM (6.5 MPM)
At Load	Amps	311
	Line Speed fpm (mpm)	4.5 FPM (1.4 MPM)

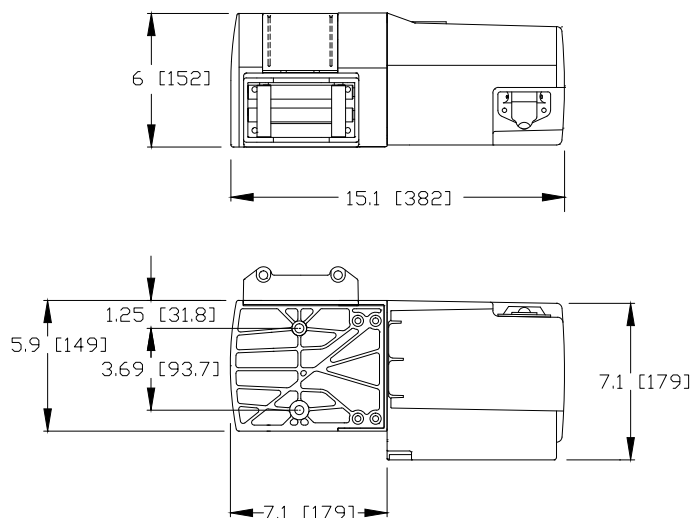

S3000

The perfect small trailer winch. This is the winch that is going to save your back and will allow you to move a load safely.



Specifications	
Model	S3000
Part Number	S104118
Rated Line Pull	3,000 lbs (1,361 kgs)
Motor	1.3 hp Permanent Magnet
Gearing	Differential Planetary
Gear Ratio	159:01:00
Solenoid	Dual "Can Style" Solenoid and Circuit Breaker Protected
Clutch	Free-Spooling, Lever Action
Brake	Mechanical and Dynamic
Rope	Wire Rope 3/16" x 60' (4.8mm x 18.2m)
Hook	Permanent/Latched
Fairlead	4-Way Roller
Remote	30' Hand-held
Dimensions	15.1" L x 8.7" D x 6.0" H (383mm L x 221mm D x 152mm H)
Drum Diameter	1.625" (41.3mm)
Drum Length	3.0" (76.2mm)
Mounting Bolt Pattern	2 Hole, 3.69" (93.7mm) on Center
Installed Weight	28.2 lbs (12.79 kgs)
Shipping Weight	31.2 lbs (14.15 kgs)
Warranty	Limited Lifetime Warranty
UPC	0 22705 00033 8

Performance		
No Load	Amps	15
	Line Speed fpm (mpm)	17 FPM (5.1 MPM)
At Load	Amps	220
	Line Speed fpm (mpm)	4.5 FPM (1.4 MPM)

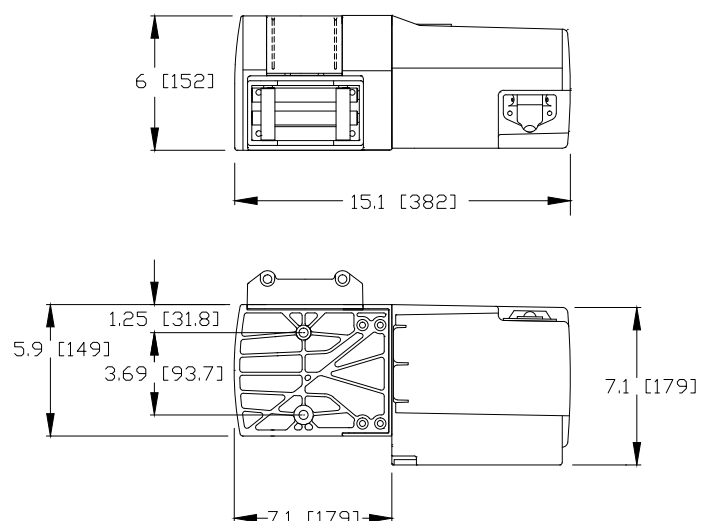

Portable Winches



Winch2Go



Specifications		
Model	WINCH2GO	WINCH2GO SR
Part Number	1140222	1140232
Rated Line Pull	4,000 lbs (1814 kg)	
Motor	1.4 hp (1.0 kW) 12V DC	
Gear Ratio	166:01:00	
Freespool Clutch	Cam Action Knob	
Drum Barrel Diameter	2.0" (50.8 mm)	
Drum Length	3.03" (77.0 mm)	
Cable	3/16" X 50' (4.8 mm X 15.24 m)	
Installed Weight	43 lbs (19.5 kg)	41 lbs (19.5 kg)
Switching Method	Sealed Handheld Rocker Switch	
Fairlead	Hawse Fairlead in Baseplate	
Line Pull: 0 lbs	20 Amps Motor Draw / 20.0 FPM (6.0 MPM)	
Line Pull: 4,000 lbs	220 Amps Motor Draw / 5.5 FPM (1.6 MPM)	
Warranty	Limited Two Year Warranty	
Battery Lead	10'	10' with alligator clip



Utility Winches

Our go-to winch collection, Superwinch builds the finest utility winches in the business. Surprisingly small in size, but massive in pulling power, these utility winches will go well above the call of duty.

UT3000

The UT3000 is a workhorse with 3,000 lbs of pulling capacity, freespool control and cable tensioner to keep your cable wrap tight.



Specifications	
Model	UT3000
Part Number	1331200
Voltage	12VDC
Rated Pull lbs (kg)	3000 (1361)
Motor hp (kW)	1.2 (.89)
Gearing	1-Stage Planetary
Gear Ratio	153:1
Solenoid	Circuit Breaker Protected
Freespool	Pull and Turn
Brake	Dynamic
Rope Length ' (m)	100 (30.5)
Rope Dia " (mm)	5/16 (7.9)
Hook	Clevis Pinned
Fairlead/Hawse	4-Way Fairlead
Remote Control	12' Rubberized
Weight Installed lbs (kg)	19.5 (8.84)
Weight Shipping lbs (kg)	22.3 (10.11)
Warranty	Limited 1-Year
UPC	0 22705 00272 1

Performance		
No Load	Amps	5
	Line Speed fpm (mpm)	8.5 (2.58)
At Load	Amps	110
	Line Speed fpm (mpm)	2.2 (0.6)

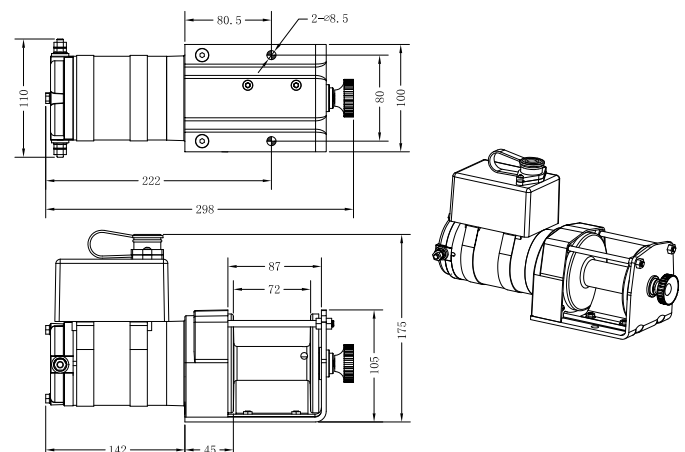

X Series

X1



X2



X3F



X Series Specifications

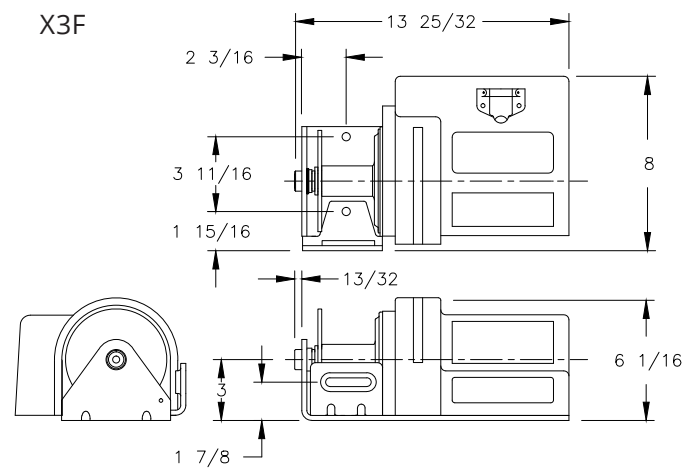
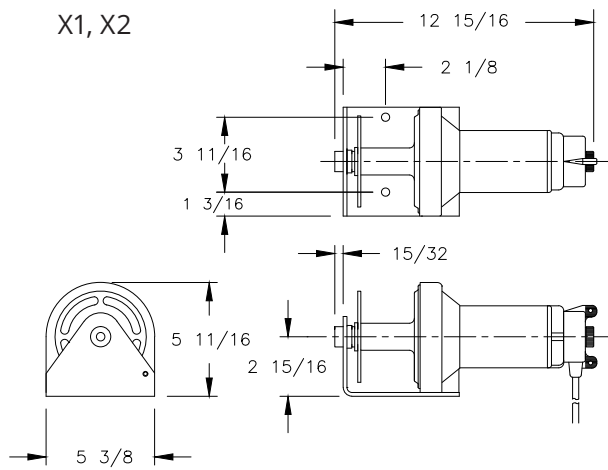

Specifications			
Model	X1	X2	X3F
Part Number	1101	1201	1307
Rated Line Pull	2,000 lbs (907 kgs)	3,000 lbs (1,361 kgs)	4000 lbs (1814 kg)
Motor	1.8 HP (1.34 kw) Series Wound	1.8 HP (1.34 kw) Series Wound	2.0 hp (1.5 kW) Permanent Magnet
Gearing	Differential Planetary	Differential Planetary	Differential Planetary
Gear Ratio	123:01:00	148:01:00	148:01:00
Solenoid	Solenoid & Circuit Breaker Protected	Solenoid & Circuit Breaker Protected	Circuit Breaker Protected
Clutch	Tensioner	N/A	Pull and Turn
Brake	Dynamic	Dynamic	Dynamic
Rope	Wire 3/16" x 25' (4.8mm x 7.6m)	Wire 7/32" x 40' (5.6mm x 12.19m)	50 ft x 7/32 in (15.2 m x 5.6 mm)
Hook	Latched	Latched	Permanent with Latch
Fairlead	N/A	Hawse	Integrated
Remote	N/A, On the Motor Switching	N/A, Removable On the Motor Switching	15' Handheld
Dimensions	12.81" L x 5.38" D x 5.69" H (325mm L x 137mm D x 146mm H)	12.81" L x 6.13" D x 5.69" H (325mm L x 156mm D x 146mm H)	15.36 in L x 8.0 in D x 6.06 in H (90 mm x 203 mm x 154 mm)
Drum Diameter	1.5" (38mm)	1.5" (38mm)	1.63 in (32mm)
Drum Length	2.6" (66mm)	2.6" (66mm)	2.6 in (66 mm)
Mounting Bolt Pattern	2 Hole 3.69" (94mm) on Center	2 Hole 3.69" (94mm) on Center	2- Hole: 3.69 in (94mm) On Center
Installed Weight	15 lbs (8.16 kgs)	19 lbs (8.6 kgs)	15 lbs (7 kgs)
Shipping Weight	18.0 lbs (8 kgs)	22 lbs (9.9 kgs)	18 lbs (8.16 kgs)
Warranty	One-Year Limited	One-Year Limited	One-Year Limited
UPC	0 22705 01101 3	0 22705 01201 0	02270 00202 8

Performance				
Model		X1	X2	X3F
No Load	Amps	30	30	35
	Line Speed FPM (MPM)	25.5 FPM (7.8 MPM)	27 FPM (8.2 MPM)	33 FPM (9.1 MPM)
At Load	Amps	200	223	290
	Line Speed FPM (MPM)	7.0 FPM (2.1 MPM)	4.3 FPM (1.3 MPM)	3.5 FPM (1.1 MPM)

AC3000/AC2000

Available in 3,000 and 2,000 pound capacities, these AC winches offer pulling power for 120 AC. Includes drum switch remote ready to be wired into your system.



Specifications		
Model	AC2000	AC3000
Part Number	1723	1730
Rated Line Pull	2,000 lbs (907 kgs)	3,000 lb. (1361 kg)
Motor	0.75 hp 115V AC 60 Hz Single Phase Capacitor Start TEFC	1.0 HP 3,450 RPM
Gearing	Differential Planetary	3-Stage Planetary
Gear Ratio	253:01:00	253:01:00
Duty Cycle	20 minutes "on time" at full load	Duty Cycle
Clutch	Free-Spooling Clutch: 1/4 Turn Lever	Free-Spooling Clutch: 1/4 Turn Lever
Brake	100% Automatic in the Drum	Automatic In-The-Drum
Rope	Wire Rope 5/16" x 100' (7.9mm x 30.5m)	Wire Rope 5/16" x 100' (7.9mm x 30.5m)
Hook	Heavy Duty, Clevis Pinned, Latched	Heavy Duty Clevis Latched
Fairlead	N/A	N/A
Remote	Drum Switch	N/A, Drum Switch
Dimensions	25.25" L x 8.6" D x 9.2" H (641.35mm L x 218mm D x 234mm H)	25.25" L x 8.6" D x 9.2" H (641.4mm L x 218mm D x 234mm H)
Drum Diameter	2.5" (64mm)	2.5" (64mm)
Drum Length	7.0" (177.9mm)	7.0" (177.9mm)
Mounting Bolt Pattern	4-Hole 4" x 4.5" (101.6mm x 114.3mm)	4-Hole 4" x 4.5" (101.6mm x 114.3mm)
Installed Weight	76.0 lbs (34.47 kgs)	78.0 lbs (35.38 kgs)
Shipping Weight	83 lbs (37.64 kgs)	85 lbs (38.55 kgs)
Warranty	Limited Lifetime Warranty	Limited Lifetime Warranty
UPC	0 22705 01723 7	0 22705 00215 8

Performance			
Model		AC2000	AC3000
No Load	Amps	6.6	7.5
	Line Speed FPM (MPM)	10.5 FPM (3.2 MPM)	10.5 FPM (3.2 MPM)
At Load	Amps	11.5	16.5
	Line Speed FPM (MPM)	10.0 FPM (3.0 MPM)	10.3 FPM (3.1 MPM)

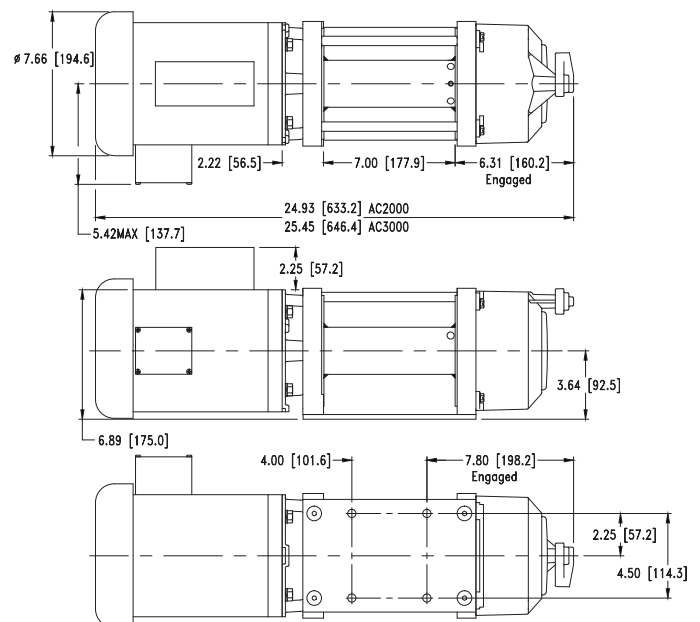

SAC 1000

This 1,000 pound winch is designed to perform on standard household current. Features a 5:1 safety factor.



Specifications	
Model	SAC 1000
Part Number	01001
Rated Line Pull	1,000 lbs (454 kgs)
Motor	0.6 HP 115V AC 50/60 Hz-Standard House Current
Gearing	1-Stage Planetary
Gear Ratio	159:1
Solenoid	Solenoid & Circuit Breaker Protected
Clutch	Free-Spooling
Brake	Mechanical and Dynamic
Rope Wire	3/16" x 50' (4.8mm x 15.2m)
Hook	Permanent, Heavy Duty Latched
Fairlead	Roller
Remote	6' (1.82m) Hand-held Sealed Pendant
Dimensions	15.25" L x 5.9" D x 6" H (387mm L x 150mm D x 152mm H)
Drum Diameter	1.62" (41.3mm)
Drum Length	3.0" (76.2mm)
Mounting Bolt Pattern	2-Hole 3.69" (93.7mm) on center
Installed Weight	33.0 lbs (15 kgs)
Shipping Weight	30.6 lbs (13.8 kgs)
Warranty	One-Year Limited Warranty
UPC	0 22705 10020 5

Performance		
No Load	Amps	4.3
	Line Speed fpm (mpm)	13.8 FMP (4.2 MPM)
At Load	Amps	10
	Line Speed fpm (mpm)	9.2 FPM (2.8 MPM)

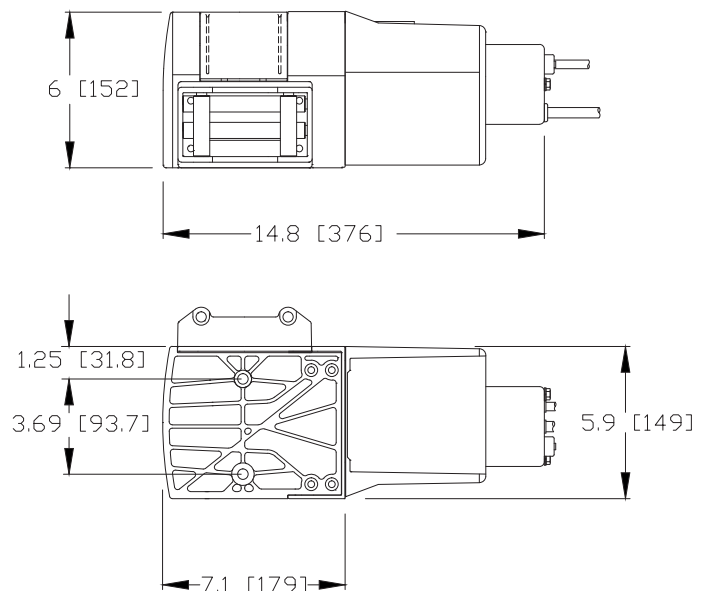

AC1000/AC1500

AC1000



AC1500



Specifications

Model	AC1000	AC1500
Part Number	1401	1715000
Rated Line Pull	1,000 lbs (454 kgs)	1,500 lbs (454 kgs)
Motor	0.6 HP 115V AC 50/60 Hz-Standard House Current	0.6 HP 115V AC 50/60 Hz-Standard House Current
Gearing	Differential Planetary	1-Stage Planetary
Gear Ratio	123:01:00	159:01:00
Duty Cycle	Circuit Breaker Protected - Resettable Push Button	Circuit Breaker Protected
Clutch	N/A	Free spooling (only on model 01001)
Brake	Automatic, Dynamic	Mechanical and Dynamic
Rope	Wire Rope 5/32" x 45' (3.9mm x 13.7m)	Wire 3/16" x 50' (4.8mm x 15.2m)
Hook	Permanent, Latched	Permanent / Standard Duty / Latched
Fairlead	N/A	Hawse
Remote	N/A (optional P/N 1560A)	6' (1.82m) Hand-held Sealed Pendant
Dimensions	13.38"l. x 5.38"d. x 5.69"h (340mm l. x 137mm d. x 145mm h.)	15.25" L x 5.9" D x 6" H (387mm L x 150mm D x 152mm H)
Drum Diameter	1.25" (31.8mm)	1.62" (41.3mm)
Drum Length	2.6" (66mm)	3.0" (76.2mm)
Mounting Bolt Pattern	2-Hole 3.69" (94mm) on Center (99mm)	2-Hole 3.69" (93.7mm) on center
Installed Weight	18.0 lbs (8 kgs)	25.4 lbs (11.5 kgs)
Shipping Weight	21.0 lbs (9.5 kgs)	28.4 lbs (12.9 kgs)
Warranty	One year Limited Warranty	One-Year Limited Warranty
UPC	0 22705 01401 4	0 22705 10010 6

Performance

Model		AC1000	AC1500
No Load	Amps	3	4.3
	Line Speed FPM (MPM)	23.0 FPM (7.0 MPM)	13.8 FPM (4.2 MPM)
At Load	Amps	10	10
	Line Speed FPM (MPM)	13.0 FPM (4.0 MPM)	9.2 FPM (2.8 MPM)

Crane Winch C1000



C1000
(with 15' Remote)



C1000
(Remote mount solenoid)



C1000
(NO Remote)

Specifications			
Model	C1000	C1000	C1000
Part Number	3002	3010	3001
Voltage	12VDC	24VDC	12VDC
Rated pull lbs (kg)	1000 (454)		
Motor HP (kW)	1.3 (096)		
Gearing	Differential Planetary		
Gear Ratio	159:01:00		
Breaker	Circuit Breaker Protected		
Freespool	N/A		
Break	Automatic Mechanical and Dynamic		
Rope Length ' (m)	N/A		
Rope Dia " (mm)	Optional P/N 1577A		
Hook	N/A		
Fairlead	4-Way Roller		
Remote Control	N/A		
Weight Installed lbs (kg)	26.8 (12.15)		29 (13.15)
Weight Shipping lbs (kg)	29.8 (13.51)		32.0 (14.51)
Warranty	Limited one year warranty		
UPC	22705300209		2270500185

Performance				
		C1000	C1000	C1000
No Load	Amps	30		
	Line Speed fpm (mpm)	19.5 (5.9)		
At Load	Amps	80		
	Line Speed fpm (mpm)	14.7 (4.5)		

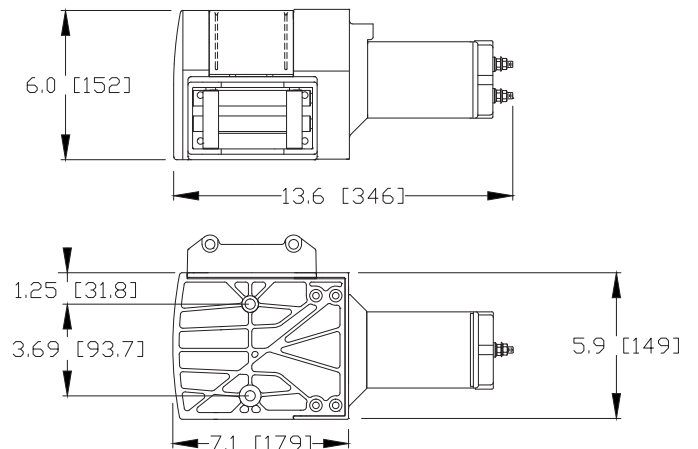

Hubs

Chevrolet/GMC/GEO

Make/Model	Year	Count	Hub#	Notes
Blazer/Jimmy/Suburban	69-91	19-Internal	400518	a
1/2 Ton Pickup	69-87	19-Internal	400518	a
3/4 Ton Pickup	77-87	19-Internal	400518	a
1 Ton Pickup	76-91	30- Internal	400439	a
Geo Tracker	All	26-6	400538	

*all 1988 Chevrolet Pickups are equipped with an automatic system which cannot be converted.

Dodge/Chrysler

1/2 ton Pickup & Ramcharger	69-75	19-Internal	400518	
1/2, 3/4 ton Pickup & Ramcharger	80-93	19-Internal	400518	
3/4 Ton Pickup	90-93	30- Internal	400439	
1 Ton Pickup (Dana 60)	90-93	30- Internal	400439	

Ford

Bronco (not Bronco II)	66-96	19-Internal	400518	a c
1/2 Ton F100 Pickup	59-86	19-Internal	400518	a c
1/2 Ton F150 Pickup	59-96	19-Internal	400518	a c
3/4 Ton F250 Pickup (D-44)	59-75	19-Internal	400518	a c
3/4 Ton F250 Pickup (D-44)	78-86	19-Internal	400518	a c
3/4 Ton F250 Pickup (D-60)	78-97	30-Internal	400439	a c
1 Ton F350 Pickup	76-97	30-Internal	400439	a c
Super Duty F 250 & F 350	00-04	30-Internal	400439	a c
Ranger	90-97	27	400565	e
Explorer	90-94	27	400565	e

International Harvester

1/2 Ton Pickup	68-75	19-Internal	400518	
Travel All	68-76	19-Internal	400518	

Isuzu

Trooper II	87-86	17-6	400533	
AMIGO	87-99	17-7	400533	
Rodeo	91-99	17-8	400533	

Jeep

CJ, Universal	81-86	27-5	400526	
J-10 Pickup	74-90	19-Internal	400518	b
J-30 Pickup	77-90	19-Internal	400518	b
Wagoneer, Cherokee, Gladiator	74-90	19-Internal	400518	b

Suzuki/Geo

Samurai, Sierra	82-94	26-6	400538	
Sidekick/Tracker All	All	26-6	400538	

Parts

334401-06	10/32 Tapered Bolt Qty: 6
-----------	---------------------------



Cautionary Foot Notes:

- When replacing full time 4wd, the (NP203 only), requires a conversion kit (See chart)
- Not compatible with Quatra Trac equipped models
- When replacing automatic 3 hole cap screw hubs, one will need to convert their spindle nuts
- One must obtain special snap ring (26 mm or 1 1/16), (Dealer item)
- When replacing automatic hubs with manual hubs, one must also change the spindle nuts

Mounting Systems



2060



1559B



2055



2050

Winch Mounts			
	Part Number	Fits	For these winches
Ball Hitch Mount	2060	Any size Ball	LT2000, S Series
2" Class III Receiver	1559B	2" Hitch	2 bolt S Series, X Series
Cradle Hitch Mount Small	2055	2 in. receiver	Small, 2 bolt pattern winches: X3, S Series
Cradle Hitch Mount Large	2050	2 in. receiver	All winches with 10 in x 4.5 in bolt pattern up to 9,500 lbs

ATV Mounting Chart

ARCTIC CAT	YEAR	SW PART #
1000 THUNDERCAT	08-13	2202873
700 ALTERA XT	2016	2202873
700 XR	2015	2202873
700 4X4 (ALL + V2,H1)	07-15	2202873
650 4X4 (ALL + V2,H1, TRV,TBX)	05-10	2202873
650 4X4 V2	2004	2202380
550 4X4 (Including TRV)	09-12	2202873
500 XR	2015	2202873
ALTERA 500	2016	2202873
500 TRV CORE	2013	2202873
500 4X4 (ALL Except 05 TRV)	05-09	2202873
500 4X4 TRV 2-UP	2005	2202380
500 4X4 (ALL + TBX/TRV)	02-04	2202380
500 4X4 (ALL)	99-01	2202350
454 4X4 BEAR CAT	96-98	2202350
450 4X4 (+ TRV)	10-12	2202873
400 4X4 (ALL + TBX/TRV)	06-10	2202873
400 4X4 (ALL Including TBX/TRV)	02-05	2202380
400 4X4	98-01	2202350
400 4x4	2014	2202897
3754X4 AUTOMATIC	2002	2202380
366 4X4	08-09	2202897
350 4x4	11-12	2202897
300 4X4	02-05	2202380
300 4X4	98-01	2202350
250 2x4 / 4X4	2001	2202350
650 & 700 PROWLER 4X4 or H1 XTX	06-08	2202892

CAN-AM/BOMBARDIER	YEAR	SW PART #
800 OUTLANDER 4X4	06-11	2202893
800 OUTLANDER MAX 2-UP	06-11	2202893
650 OUTLANDER 4X4	06-11	2202893
650 OUTLANDER 4X4 MAX 2-UP	06-11	2202893
500 OUTLANDER MAX 4X4	07-11	2202893
500 OUTLANDER 4X4	07-11	2202893
400 OUTLANDER MAX 2-UP	04-11	2202865
400 OUTLANDER 4X4	03-14	2202865
330 OUTLANDER 4X4	04-05	2202865
COMMANDER 800 / 1000 (UTV)*	11-17	2202913
MAVERICK 1000*	13-15	2202916
MAVERICK 1000 TURBO	2016	2202916

HONDA	YEAR	SW PART #
TRX 650/680 RINCON (ALL)	03-15	2202867
TRX 500 FOREMAN	12-13	2202910
TRX 500 FOREMAN (4-BOLT WINCHES ONLY)	14-17	2202921
TRX 500 FOREMAN RUBICON	15-17	2202921
TRX 500 FOREMAN RUBICON	09-14	2202898
TRX 500 FORMAN / RUBICON (ALL)	07-08	2202878
TRX 500 FOREMAN E.S.	05-05	2202877
TRX 500 FOREMAN / RUBICON & GPSCAPE	05-06	2202879
TRX 500 FOREMAN / RUBICON (ALL)	01-04	2202879
TRX 475 FORMAN PS, EPS (FOOTSHIFT)	2009	2202898
TRX 450 FOREMAN 4X4 (ALL)	98-04	2202381
TRX 420 RANCHER (ALL) (4x2 fits LT winches only)	07-13	2202889
TRX 420 RANCHER (INDEPENDENT REAR)	2014	2202889
TRX 420 RANCHER (INDEPENDENT REAR)	15-17	2202921
TRX 420 RANCHER (STRAIGHT AXLE)	14-17	2202921
TRX 400 RANCHER (ALL)	04-07	2202375
TRX 400 4X4	95-01	2202381
TRX 350 RANCHER (ALL)	00-06	2202375
TRX 300 2X4 / 4X4	93-00	2202352
TRX 250 RECON (ALL)	97-16	2202911
BIG RED (UTV)*	09-13	2202903
PIONEER (+ PIONEER-4)*	14-16	2202918
PIONEER 500*	15-17	2202925

KAWASAKI	YEAR	SW PART #
750 BRUTE FORCE 4X4	05-17	2202881
700 PRAIRIE 4X4	04-06	2202382
650 BRUTE FORCE INDEPENDENT AXLE	2011	2202881
650 BRUTE FORCE STRAIGHT AXLE	06-13	2202899
650 BRUTE FORCE STRAIGHT AXLE	2005	2202875
KVF 650 PRAIRIE 4X4	02-03	2202382
360 PRAIRIE (ALL)	03-11	2202846
4010 MULE (2 AND 4 DOOR, EXCL DIESEL)	09-16	2202902
4010 MULE DIESEL (2 & 4 DOOR) (UTV)	05-07	2202868
3010 MULE TRANS 4X4 DIESEL (4DR) (UTV)	05-07	2202868
550 MULE 4X4(UTV)	2004	2202868
610 MULE (UTV)*	05-16	2202882
620 MULE 4X4 (UTV)	03-05	2202868
750 TERYX 4X4 (UTV) +2014 SPORT*	08-13	2202891
750 TERYX 4 DOOR*	12-13	2202917
800 TERYX 4X4 (+ LE)*	14-16	2202917
800 TERYX 4 DOOR*	2014	2202917

JOHN DEERE	YEAR	SW PART #
RSX 850*	12-13	2202924
GATOR 855D*	2013	2202923
GATOR 825I*	11-16	2202923
GATOR XUV 550	13-16	2202924

POLARIS	YEAR	SW PART #
SPORTSMAN 1000	15-17	2202900
SCRAMBLER 1000 XP	15-17	2202900
900 ACE	2016	2202900
SCRAMBLER 850 SP	14-16	2202900
SCRAMBLER 850	13-14	2202900
850 SPORTSMAN XP (+ TOURING)	09-17	2202900
850 SPORTSMAN HO High Lifter	2016	2202900
800 SPORTSMAN 4X4	11-14	2202900
800 SPORTSMAN 4X4	05-10	2202863
800 SPORTSMAN 800 X2 & TOURING TWO-UP	07-09	2202863
700 SPORTSMAN 4X4 X2 TWO-UP	2008	2202863
700 SPORTSMAN 4X4	02-07	2202863
600 SPORTSMAN 4X4	03-05	2202863
570 ACE (ACE 2014) SP (2016)	2016	2202900
570 SPORTSMAN 4X4 (+ TOURING)	14-17	2202900
550 XP SPORTSMAN (+ TOURING /X2)	09-15	2202900
500 SPORTSMAN 4X4 X2 TWO-UP	06	2202887
500 SPORTSMAN 4X4 X2 TWO-UP	07-09	2202863
500 ATP HO 4X4	04-05	2202872
500 SPORTSMAN 4X4	11-13	2202900
500 SPORTSMAN 4X4	04-10	2202863
500 SPORTSMAN 4X4	96-03	2202872
500 SPORTSMAN 6X6	00-08	2202872
500 MAGNUM / XPLOER 4X4	99-00	2202872
455 DIESEL 4X4	99-00	2202872
450 SPORTSMAN 4X4	06-07	2202863
SPORTSMAN 450	16-17	2202900
425 XPEDITION 4X4	2000	2202872
400 HO SPORTSMAN	11-14	2202900
400 HO SPORTSMAN	08-10	2202912
400 SPORTSMAN 4X4	04-05	2202863
400 SPORTSMAN 4X4	00-06	2202872
400 XPLOER 4X4	95-02	2202872
370 ACE 4X4	2014	2202900
335 SPORTSMAN 4X4	98-00	2202872
330 ATP 4X4	04-05	2202872
325/330 MAGNUM 4X4	00-06	2202872
325 SPORTSMAN EXT 4X4	2015	2202900
300 SPORTSMAN 4X4	08-10	2202912
300 HAWKEYE	06-07	2202912
RZR 1000/RZR-4 1000*	14-16	2202927
RZR 900/900S	15-16	2202927

RANGER RZR 900 (UTV)	11-14	2202914
RANGER RZR 800, RZR-S, RZR 4 (UTV)	08-14	2202890
RANGER 900 XP (+ CREW)*	13-16	2202919
RANGER 900 DIESEL, (UTV)*	2011	2202894
RANGER 800 (UTV)*	10-14	2202894
RANGER 800 (MIDSIZE) (UTV)*	13-14	2202915
RANGER 700 (UTV)*	2009	2202894
RANGER 700 (UTV)*	05-08	2202871
RZR 570 (UTV)	12-16	2202890
RANGER 570 (FULL SIZE)	2016	2202915
RANGER 570 (FULL SIZE)*	2015	2202919
RANGER 570 (MID SIZE)*	15-16	2202915
RANGER 570*	2014	2202915
RANGER 500 (UTV)*	11-13	2202915
RANGER 500 (UTV)*	09-10	2202894
RANGER 500 (UTV)*	03-08	2202871
RANGER 400 *	10-13	2202915
RANGER 325*	15-16	2202915
RANGER EV ELECTRIC*	12-15	2202915

SUZUKI	YEAR	SW PART #
750 KING QUAD (+rugged)	08-17	2202874
700 TWIN PEAKS	04-05	2202382
700 KING QUAD	05-07	2202874
500 VINSON 4X4 (ALL)	02-07	2202387
500 KING QUAD	09-17	2202874
450 KING QUAD	07-10	2202874
400 KING QUAD	08-07	2202895
400 EIGER (ALL)	02-07	2202387
620 4X4 Q.U.V. (UTV)	2005	2202868

YAMAHA	YEAR	SW PART #
00 GRIZZLY 4X4 (ALL)	07-15	2202883
660 GRIZZLY 4X4	02-08	2202383
550 GRIZZLY (ALL)	09-14	2202883
450 GRIZZLY 4X4	07-08	2202866
450 GRIZZLY 4X4	09-14	2202866
450 WOLVERINE 4X4	06-09	2202896
450 KODIAK 4X4	03-06	2202866
400 BIG BEAR 4X4	07-11	2202866
400 BIG BEAR 4X4	00-06	2202377
400 KODIAK 4X4	03-05	2202866
400 GRIZZLY 4X4	2007	2202866
350 GRIZZLY 4X4	07-14	2202866
350 BRUIN 350 4X4	04-06	2202866
350 WOLVERINE 2X4	06-09	2202896
350 WOLVERINE 4X4	95-05	2202365
RHINO 700 (UTV)*	08-13	2202908
RHINO 660 (UTV)*	04-07	2202908
RHINO 450 (UTV)*	06-09	2202908
VIKING 700*	14-15	2202920
VIKING-6 700*	15-16	2202920

Winch Rigging



Accessory Kits



Accessory Kits		
Kit	Part Number	Contents
ATV/UTV Accessory Kit	2302286	<ul style="list-style-type: none"> • 8,000lb capacity pulley block • 1 Bow shackle • 1 in x 8 ft tree-saver strap • Winching leather gloves • Rugged denier polyester/PVC carry bag
Small Accessory Kit	1554	<ul style="list-style-type: none"> • 10,000lb capacity pulley block • 6 ft x 2 in wide tree saver/recovery strap • Heavy Duty Leather Palmed Gloves • Rugged 600 denier polyester/PVC Carry Bag
Large Accessory Kit	2224	<ul style="list-style-type: none"> • 20,000 lb capacity swing-away pulley block • 1/2 in Superwinch bow shackles (2) • 3 in x 8 ft nylon recovery strap • Heavy Duty Leather Palmed Gloves • Rugged 600 denier polyester/PVC Carry Bag

Bow Shackles, Pulley Blocks & Rope Extensions

Bow Shackles

2538
Heavy-duty steel large capacity



2302285
ATV Heavy-duty steel shackles



Pulley Blocks



Rope Extensions

Superwinch Rope Extensions		
Part Number	Diameter	Length
2240	8-Mar	25 ft
2241	8-Mar	50 ft
2242	8-Mar	75 ft
2243	8-Mar	100 ft
2244	2-Jan	25 ft
2245	2-Jan	50
2246	2-Jan	75
2247	2-Jan	100



Superwinch Kinetic Rope			
	Part Number	Diameter	Length
Kangaroo Rope - Kinetic Recovery Rope 20 ft	2590	7/8 in	20 ft
Kangaroo Rope - Kinetic Recovery Rope 30 ft	2591	7/8 in	30 ft

Straps & Gloves



2517

Straps				
Application	Ultimate Strength	Length x Width	Part Number	Notes
Powersports/Utility	8,000	1"x8'	2302284	Flat eye, perfect for use as a tree-saver
Truck, Jeep, SUV, Industrial	15,600	2"x20'	2517	Assembly-Twisted loop eye (type 4) each end with 2 inch loop eye width, reinforced loop- inside only
Truck, Jeep, SUV, Industrial	15,600	2"x30'	2518	Assembly-Twisted loop eye (type 4) each end with 2 inch loop eye width, reinforced loop- inside only
Truck, Jeep, SUV, Industrial	15,600	2"x6'	1059	Loop eye length 7 inches, Load bearing splice 9 inches, Length 30 Ft-loop eye end to loop eye end
Truck, Jeep, SUV, Industrial	23,500	3"x8'	2531	Loop eye length 7 inches, Load bearing splice 9 inches, Length 8 Ft loop eye end to loop eye end

Superwinch Gloves		
	Part Number	Size, Feature
Leather Palmed Gloves	90-22611	One size fits all. Perfect for wire cable.
Synthetic Rope Gloves	2585	XXL - High Vis Yellow, with capacitive touch
	2584	XL- High Vis Yellow, with capacitive touch
	2583	L - High Vis Yellow, with capacitive touch
	2582	XXL- Blue, with capacitive touch
	2581	XL- Blue, with capacitive touch
	2580	L - Blue, with capacitive touch



2583

Covers, Remotes & Electrical



1571

Neoprene Covers		
Winch Style	Part Number	Fits
Off Road/Recovery	1570	Talon 9.5 & 12.5, Rock 98, Tiger Shark 9,500 & 11,500, LP 8500 & LP 10,000, EP 9.0, Rock 95 and X9 winches.
Off Road/Recovery - Integrated	1571	Talon 9.5i & 12.5i, EP 9i and S9000 winches
Large Chassis Off Road/Recovery	1572	Talon 14, 18, Tiger Shark 13500, 15,500, & 17500, EP 12, and EP16.
Trailer Winch Small	1573	S3000,S4000,S4500,S5000
Trailer Winch, Large	1574	S5500 and S7500
ATV/UTV	2302297	Superwinch Terra, LT, UT, X1,X2,X3 and other small winches

Remote Controls			
	Part Number	Designed For	Features
EXP Wireless	S103393	EXP Series (all)	125 ft Range, Auto-Off, Haptic Vibrations
Certus	6718	S Series	Plug and Play, FM signal, IP67
	6716	Terra ATV Series	Plug and Play, FM signal, IP68
	6714	Talon Series	Plug and Play, FM signal, IP69
	6724	Tiger Shark Series	Plug and Play, FM signal, IP70



Electrical				
Wiring Kit	PN	Length	Gauge	Designed for
Trailer Wiring Kit - Small Winch	1520	19 ft	6 AGW	Winches up to 4,000 lb in capacity
Trailer Wiring Kit - Large Winch	2008	25 ft	2 AGW	Winches 5,000-18,000 lb in capacity
Solenoid Relocation Kit Short	2302283	20 inch	2 AGW	Winches 8,000 lb -18,000 lb
Solenoid Relocation Kit Long	2302282	72 inch	2 AGW	Winches 8,000 lb -18,000 lb
5' Wiring Kit	2007	5 ft	2AGW	Winches 5,000-18,000 lb in capacity

Superwinch Industrial



SI Series 12,000 Electric

Model: 12,000, SAE J706 Electric Motor Type: Electric 12 VDC

(see description)

- State of the art design expressly for industrial needs
- Built on flexible chassis for easy conversions and fast lead times

Part Numbers	
S100349	Industrial-12-Winch-DC-12-Anti Clock- J706- Standard Drum
S100361	Industrial-12-Winch-DC-12-Anti Clock- J706- Narrow Drum
S100373	Industrial-12-Winch-DC-12-Anti Clock- J706- Wide Drum

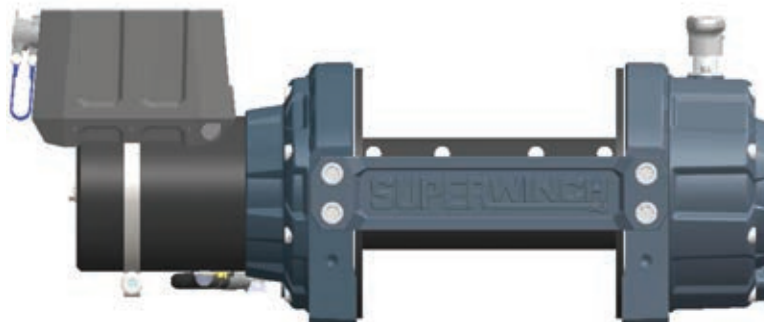

Engineering Data	
Maximum Pulling Force	Layer 1: 12,000 Lbs. (53.4 KN) Layer 2: 10,072 Lbs. (44.8 KN) Layer 3: 8,678 Lbs. (38.6 KN) Layer 4: 7,623 Lbs. (33.9 KN) Layer 5: 6,796 Lbs. (30.2 KN)
Geartrain	3-Stage Planetary
Gear Ratio	210:1
Clutch	Multi Position, Manual Pull & Turn Available Pneumatic and Cable
Brake	Hydraulic Release, Spring Applied, Multi disc failsafe dry brake
Fairlead	Not Included, See Page 2 for Part Info

Dimensional Data (See Dimensional Drawing for More Information)	
Drum Barrel Diameter	90mm
Rope Attachment Points	2 Points (for right or left lay rope) Pass through to retain safety wraps
Recommended Rope and Capacity	Narrow Drum 136 FT x 3/8 IN (41.4m x 9.5mm) Standard Drum 170 FT x 3/8 IN (51.7m x 9.5mm) Wide Drum 203 FT x 3/8 IN (61.9 x 9.5mm)
Maximum Wire Rope Recommendation	3/8 IN (9.5mm)
Minimum Breaking Strength	15100 lbs (67.1 KN)
Approximate Shipping Weight (without rope)	Narrow 119lbs (53.97 kgs) Standard 125lbs (56.69 kgs) Wide 131lbs (59.42 kgs)

Performance Data		
Load	Amps	FPM
0	100	35
2000	175	22
4000	255	15.5
6000	320	12.5
8000	390	10
10000	460	8.5
12000	515	7

Electrical System Specifications	
Maximum Watts	6180W
Maximum Amperage	515A
Duty Cycle	Intermittent per SAE J706 section 6.2 200 degrees F (93°C)
Lubrication	Synthetic Grease PN S102307
Standards Compliance	SAE J706

No Load Line Speed By Layer		
Layer 1	35 FPM	10.6 MPM
Layer 2	41 FPM	12.5 MPM
Layer 3	47 FPM	14.3 MPM
Layer 4	53 FPM	16.2 MPM
Layer 5	59 FPM	18 MPM

22.5 Degrees of Rotation for Motor and Gearbox

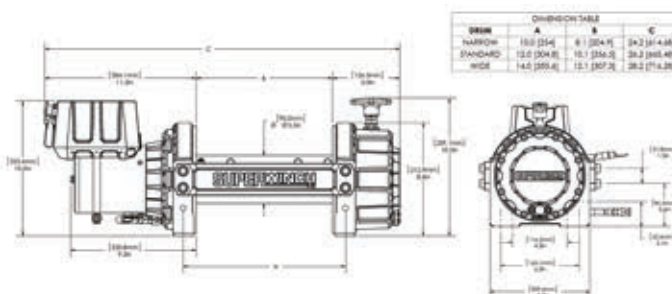
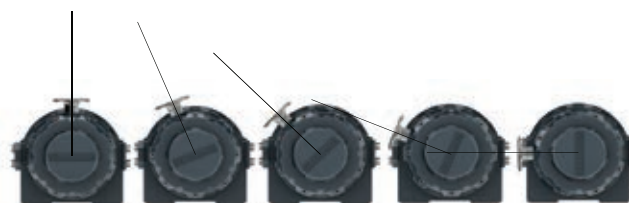

SI Series 12,000 Hydraulic

Model: 12,000, J706, Hydraulic
Motor Type: Hydraulic 160cc

- Heavy duty performance
- Built on flexible chassis for easy conversions and fast lead times

Part Numbers	
S100421	Industrial-10-Winch-HY-1S- J706- Standard Drum
S100424	Industrial-10-Winch-HY-1S- J706- Narrow Drum
S100427	Industrial-10-Winch-HY-1S- J706- Wide Drum



Engineering Data	
Maximum Pulling Force	Layer 1: 12,000 Lbs. (53.4 KN) Layer 2: 10,072 Lbs. (44.8 KN) Layer 3: 8,678 Lbs. (38.6 KN) Layer 4: 7,623 Lbs. (33.9 KN) Layer 5: 6,796 Lbs. (30.2 KN)
Geartrain	2-Stage Planetary
Gear Ratio	16:01
Clutch	Multi Position, Manual Pull & Turn Available Pneumatic and Cable
Brake	Hydraulic Release, Spring Applied, Multi disc failsafe dry brake
Fairlead	Not Included, See Page 2 for Part Info

Hydraulic System Specifications	
Maximum Input Pressure	2050 PSI (142 Bar)
Maximum Input Flow	15 GPM (57 LPM)
Duty Cycle	Intermittent per SAE J706 section 6.2 200 degrees F (93°C)
Lubrication	Synthetic Grease PN S102307
Standards Compliance	SAE J706
Gear Ratio	16:01
Gearbox	2-Stage Planetary
Load Block	Superblock Bidirectional Load Control Valve & Brake Controller

Dimensional Data (See Dimensional Drawing for More Information)	
Drum Barrel Diameter	3.5 IN (90mm)
Rope Attachment Points	2 Points (for right or left lay rope) Pass through to retain safety wraps
Recommended Rope and Capacity	Narrow Drum 136 FT x 3/8 IN (41.4m) Standard Drum 170 FT x 3/8 IN (51.7m) Wide Drum 203 FT x 3/8 IN (61.9)
Maximum Wire Rope Recommendation	3/8 IN (9.5mm)
Minimum Breaking Strength	15100 lbs (71.2KN)
Approximate Shipping Weight (without rope)	105 lbs (47.6 kgs)

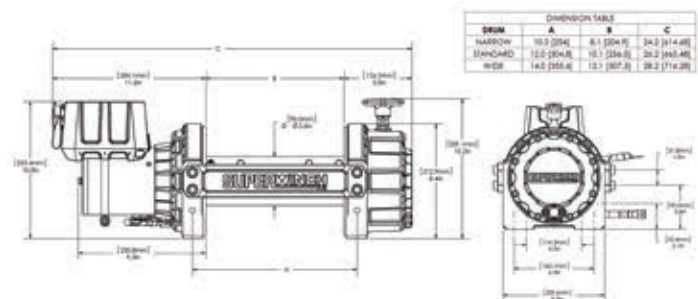
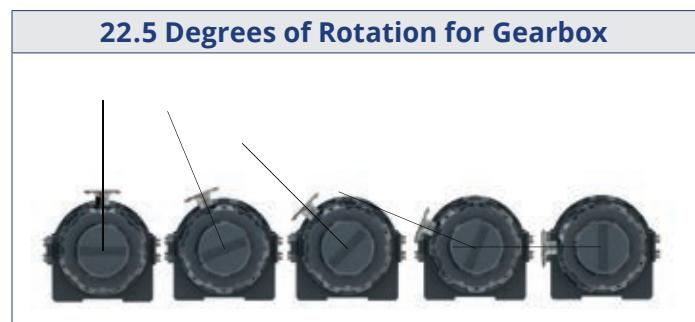

SI Series 10,000 Electric

Model: 10,000, J706 Electric
Motor Type: Electric 12 VDC

(see description)

- State of the art design expressly for industrial needs
- Built on flexible chassis for easy conversions and fast lead times

Part Numbers	
S100348	Industrial-10-Winch-DC-12-Anti Clock- J706- Std Drum
S100360	Industrial-10-Winch-DC-12-Anti Clock- J706- Narrow Drum
S100372	Industrial-10-Winch-DC-12-Anti Clock- J706- Wide Drum

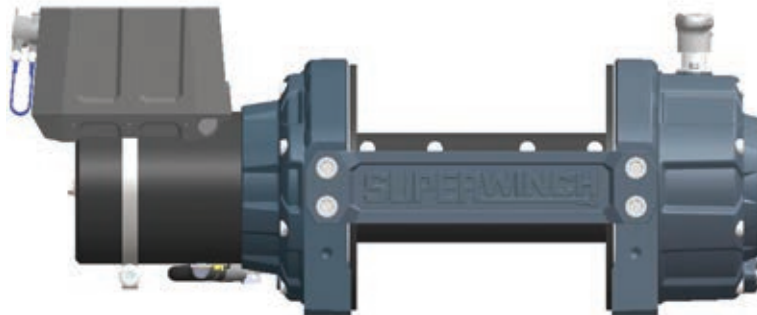

Engineering Data	
Maximum Pulling Force	Layer 1: 10,000 Lbs. (44.4 KN) Layer 2: 8,393 Lbs. (37.3 KN) Layer 3: 7,232 Lbs. (32.1 KN) Layer 4: 6,352 Lbs. (28.2 KN) Layer 5: 5,664 Lbs. (25.2 KN)
Geartrain	3-Stage Planetary
Gear Ratio	210:1
Clutch	Multi Position, Manual Pull & Turn Available Pneumatic and Cable
Brake	Hydraulic Release, Spring Applied, Multi disc failsafe dry brake
Fairlead	Not Included, See Page 2 for Part Info

Dimensional Data (See Dimensional Drawing for More Information)	
Drum Barrel Diameter	90mm
Rope Attachment Points	2 Points (for right or left lay rope) Pass through to retain safety wraps
Recommended Rope and Capacity	Narrow Drum 68 FT x 3/8 IN (20.6m) (25.7m x 11mm) Standard Drum 170 FT x 3/8 IN (51.7m x 9.5mm) Wide Drum 203 FT x 3/8 IN (61.9m x 9.5mm)
Maximum Wire Rope Recommendation	3/8 IN (9.5mm)
Minimum Breaking Strength	15100 lbs (67.1KN)
Approximate Shipping Weight (without rope)	Narrow 113lbs (51.25 kgs) Standard 118lbs (53.52 kgs) Wide 122lbs (55.33 kgs)

Performance Data			
Load	Amps	FPM	MPM
0	100	33	10
2000	190	19	5.8
4000	275	14	4.3
6000	350	11	3.3
8000	420	8.5	2.6
10000	490	7	2.1

Electrical Specifications	
Maximum Watts	5580W
Maximum Amperage	490A
Remote Control Style	Wired, Heavy Duty, 15 FT (4.5m) Cord. Wireless Available
Duty Cycle	Intermittent per SAE J706 section 6.2 200 degrees F (93°C)
Lubrication	Synthetic Grease PN S102307
Standards Compliance	SAE J706

Line Speed By Layer		
Layer 1	34 FPM	10.05 M
Layer 2	39 FPM	11.88 M
Layer 3	45 FPM	13.71 M
Layer 4	50 FPM	15.24 M
Layer 5	56 FPM	17.07 M

22.5 Degrees of Rotation for Motor and Gearbox

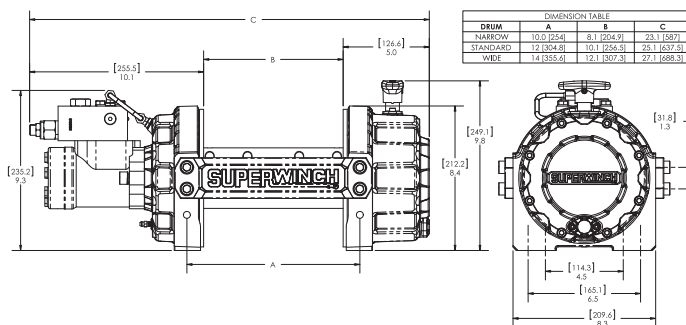
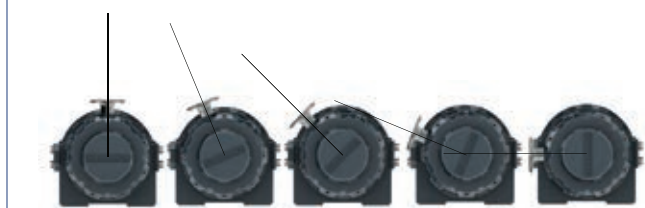

SI Series 10,000 Hydraulic

Model: 10,000, SAE J706, Hydraulic
Motor Type: Hydraulic 120cc

- Heavy duty performance
- Built on flexible chassis for easy conversions and fast lead times

Part Numbers	
S100420	Industrial-10-Winch-HY-1S- J706- Std Drum
S100423	Industrial-10-Winch-HY-1S- J706- Narrow Drum
S100426	Industrial-10-Winch-HY-1S- J706- Wide Drum



Engineering Data	
Maximum Pulling Force	Layer 1: 10,000 Lbs. (44.4 KN) Layer 2: 8,393 Lbs. (37.3 KN) Layer 3: 7,232 Lbs. (32.1 KN) Layer 4: 6,352 Lbs. (28.2 KN) Layer 5: 5,664 Lbs. (25.2 KN)
Geartrain	2-Stage Planetary
Gear Ratio	16:01
Clutch	Multi Position, Manual Pull & Turn Available Pneumatic and Cable
Brake	Hydraulic Release, Spring Applied, Multi disc failsafe dry brake
Fairlead	Not Included, See Page 2 for Part Info

Hydraulic System Specifications	
Maximum Input Pressure	2050 PSI (142 Bar)
Maximum Input Flow	15 GPM (57 LPM)
Duty Cycle	Intermittent per SAE J706 section 6.2 200 degrees F (93°C)
Lubrication	Synthetic Grease PN S102307
Standards Compliance	SAE J706
Gear Ratio	16:01
Gearbox	2-Stage Planetary
Load Block	Superblock Bidirectional Load Control Valve & Brake Controller

Dimensional Data (See Dimensional Drawing for More Information)	
Drum Barrel Diameter	(90mm)
Rope Attachment Points	2 Points (for right or left lay rope) Pass through to retain safety wraps
Recommended Rope and Capacity	Short Drum 136 FT x 3/8 IN (41.4m) Standard Drum 170 FT x 3/8 IN (51.7m) Long Drum 203 FT x 3/8 IN (61.9)
Maximum Wire Rope Recommendation	3/8 IN (9.5mm)
Minimum Breaking Strength	15100 lbs (71.2KN)
Approximate Shipping Weight (without rope)	Narrow 104 lbs Standard 109 lbs Wide 113 lbs

Line Pull At Pressure (15 GPM)	
Line Pull	Pressure
10,000	2050 PSI
7,500	1650 PSI
5,000	1200 PSI
2,500	800 PSI
Minimum	400 PSI

Performance Data—10K				
	15 GPM (56LPM)		10 GPM (37LPM)	
	Ft/Min	M/Min	Ft/Min	M/Min
Layer 1	31	9.5	21	65
Layer 2	37	11	26	8
Layer 3	43	13	30	9
Layer 4	49	15	34	10.5
Layer 5	55	17	38	11.5

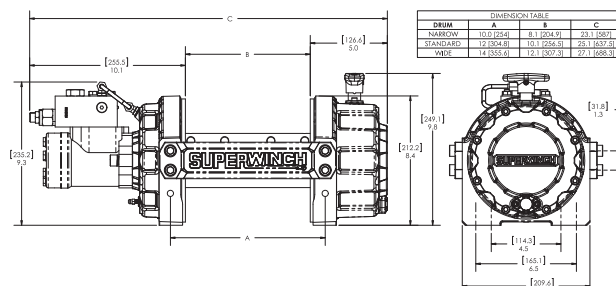
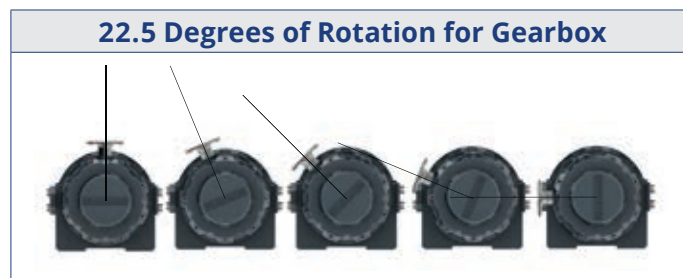

SI Series 8,000 Electric

Model: 8,000, SAE J706 Electric
Motor Type: Electric 12 VDC

- State of the art design expressly for industrial needs
- Built on flexible chassis for easy conversions and fast lead times

Part Numbers	
S100347	Industrial-8-Winch-DC-12-Anti Clock- J706- Std Drum
S100359	Industrial-8-Winch-DC-12-Anti Clock- J706- Narrow Drum
S100371	Industrial-8-Winch-DC-12-Anti Clock- J706- Wide Drum

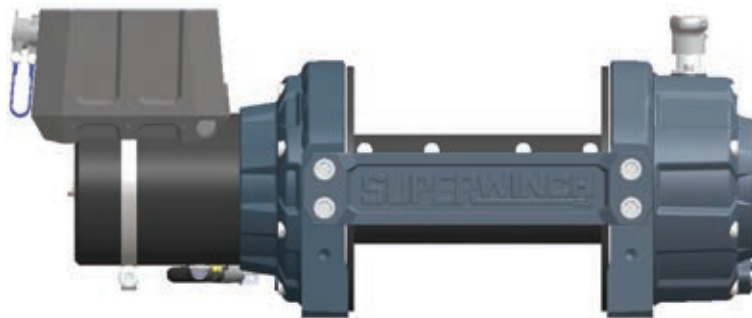

Engineering Data	
Maximum Pulling Force	Layer 1: 8,000 Lbs. (35.5 KN) Layer 2: 6,715 Lbs. (29.8 KN) Layer 3: 5,785 Lbs. (25.4 KN) Layer 4: 5,082 Lbs. (22.2 KN) Layer 5: 4,531 Lbs. (20.1 KN)
Geartrain	3-Stage Planetary
Gear Ratio	210:1
Clutch	Multi Position, Manual Pull & Turn Available Pneumatic and Cable
Brake	Electric Release, Spring Applied, Multi disc failsafe dry brake
Fairlead	Not Included, See Page 2 for Part Info

Dimensional Data (See Dimensional Drawing for More Information)	
Drum Barrel Diameter	90mm
Rope Attachment Points	2 Points (for right or left lay rope) Pass through to retain safety wraps
Recommended Rope and Capacity	Narrow Drum 136 FT x 3/8 IN (41.4m x 9.5mm) Standard Drum 170 FT x 3/8 IN (51.7m x 9.5mm) Wide Drum 203 FT x 3/8 IN (61.9m x 9.5mm)
Maximum Wire Rope Recommendation	3/8 IN (9.5mm)
Minimum Breaking Strength	15,100 lbs (67.1KN)
Approximate Shipping Weight (without rope)	Narrow 107lbs (48.53 kgs) Standard 112 lbs (50.80 kgs) Wide 116 lbs (52.61 kgs)

Performance Data		
Load lbs (kg)	Speed FPM (MPM)	Amps
0	36.0 (11.0)	100
2000 (907)	21.0 (6.4)	175
4000 (1814)	14.0 (4.3)	265
6000 (2722)	10.5 (3.2)	345
8000 (3629)	6.5 (2.0)	460

Electrical Specifications	
Maximum Watts	5520W
Maximum Amperage	460A
Remote Control Style	Wired, Heavy Duty, 15 FT (4.5m) Cord. Wireless Available
Duty Cycle	Intermittent per SAE J706 section 6.2: 200 degrees F (93°C)
Lubrication	Synthetic Grease PN S102307
Standards Compliance	SAE J706

Line Speed By Layer (No Load)		
Layer 1	36 FPM	10.9 M
Layer 2	39 FPM	12.8 M
Layer 3	49 FPM	14.9 M
Layer 4	55 FPM	16.7 M
Layer 5	61 FPM	18.6 M

22.5 Degrees of Rotation for Motor and Gearbox

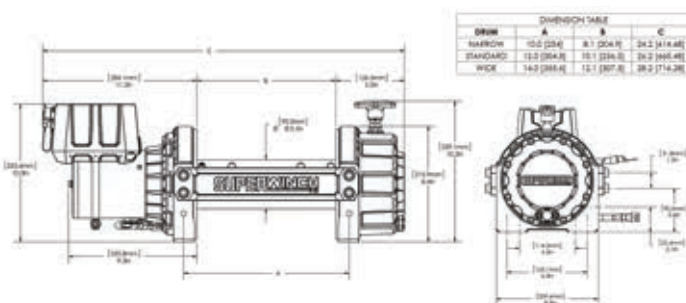
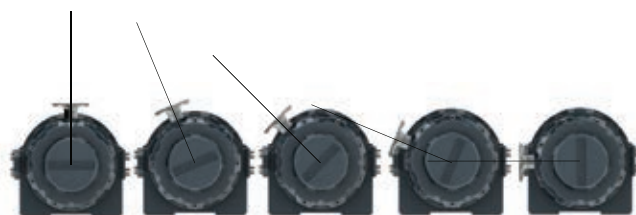

SI Series 8,000 Hydraulic

Model: 8,000, SAE J706 Hydraulic
Motor Type: Hydraulic 80cc (4.8ci)

- Heavy duty performance
- Built on flexible chassis for easy conversions and fast lead times

Part Number	
S100419	Industrial-8-Winch-HY-1S- J706- Std Drum
S100422	Industrial-8-Winch-HY-1S- J706- Narrow Drum
S100425	Industrial-8-Winch-HY-1S- J706- Wide Drum



Engineering Data	
Maximum Pulling Force (only 4 layers for EN-14492-1)	Layer 1: 8,000 Lbs. (35.5 KN) Layer 2: 6,715 Lbs. (29.8 KN) Layer 3: 5,785 Lbs. (25.4 KN) Layer 4: 5,082 Lbs. (22.2 KN) Layer 5: 4,531 Lbs. (20.1 KN)
Geartrain	2-Stage Planetary
Gear Ratio	16:1
Clutch	Multi Position, Manual Pull & Turn Available Pneumatic and Cable
Brake	Hydraulic Release, Spring Applied, Multi disc failsafe dry brake
Fairlead	Not Included, See Page 2 for Part Info

Dimensional Data (See Dimensional Drawing for More Information)	
Drum Barrel Diameter	3.54 IN (90mm)
Rope Attachment Points	2 Points (for right or left lay rope) Pass through to retain safety wraps
Recommended Rope and Capacity	Narrow Drum 136 FT x 3/8 IN (41.4m x 9.5mm) Standard Drum 170 FT x 3/8 IN (51.7m x 9.5mm) Wide Drum 203 FT x 3/8 IN (61.9 x 9.5mm)
Wire Rope Recommendation	3/8 IN (9.5mm)
Minimum Breaking Strength	15100 lbs (67.1KN)
Approximate Shipping Weight (without rope)	Narrow 103 lbs (46.72 kgs) Standard 108 lbs (48.99 kgs) Wide 112 lbs (50.80 kgs)

Performance Data—8K				
	15 GPM (56LPM)		10 GPM (37LPM)	
	Ft/Min	M/Min	Ft/Min	M/Min
Layer 1	52	16	35	10.5
Layer 2	62	19	42	13
Layer 3	72	22	49	15
Layer 4	82	25	55	17
Layer 5	92	28	62	19

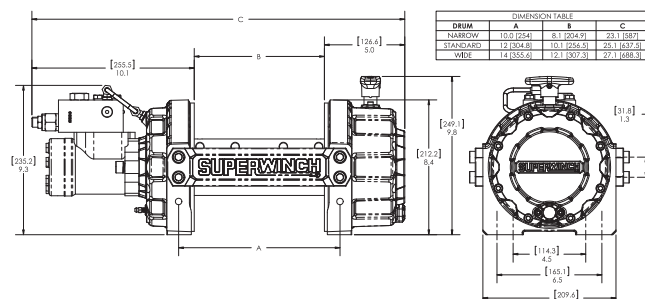
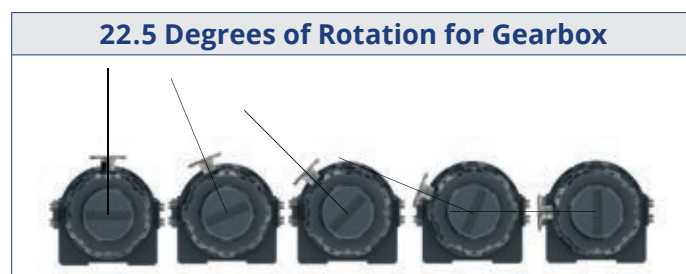

Hydraulic System Specifications	
Maximum Input Pressure	2050 PSI (150 Bar)
Maximum Input Flow	15 GPM (57 LPM)
Duty Cycle	Intermittent per SAE J706 section 6.2: 200 degrees F (93°C)
Lubrication	Synthetic Grease PN S102307
Standards Compliance	SAE J706 / EN14992
Gear Ratio	16:01
Gearbox	2-Stage Planetary
Load Block	Included

Line Pull At Pressure (15 GPM)	
Line Pull	Pressure
8,000 lbs	2200 PSI
6,000 lbs	1750 PSI
4,000 lbs	1300 PSI
2,000 lbs	850 PSI



SI Accessories

Get the most from your winch with these genuine Superwinch Accessories.

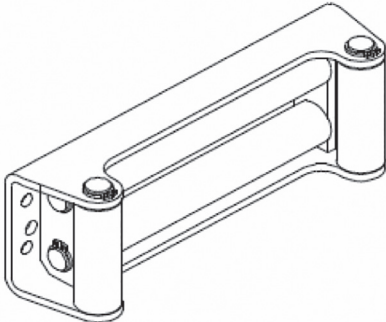
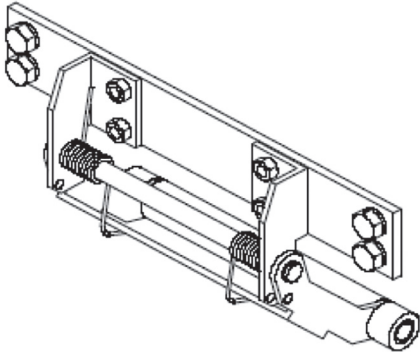
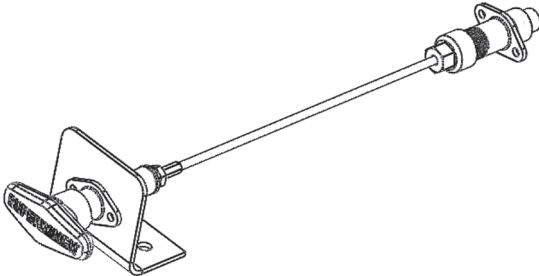
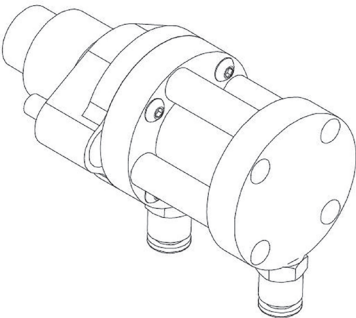
Accessories	
<p>Pulley Block Part Number: 7755 Rated to 36,000lbs</p> 	<p>Pulley Block Part Number: 7750a Rated to 20,000lbs</p> 
<p>Roller Fairlead Standard Drum Part Number – S100506 Narrow Drum Part Number – S100507 Wide Drum Part Number – S100508</p> 	<p>Cable Tensioner Standard Drum Part Number – S100500 Narrow Drum Part Number – S100501 Wide Drum Part Number – S100502</p> 
<p>Cable Clutch 2 FT Cable Clutch Part Number – S102022 6 FT Cable Clutch Part Number – S102226</p> 	<p>Air Clutch Air Clutch Small Frame Part Number – S100512</p> 



SUPERWINCH®

20750 SW 115th Ave
Tualatin, OR 97062 USA
800.323.2031 | info@superwinch.com
superwinch.com